



Knot Monsters

FARMER'S MARKET Edition

50 Amigurumi Crochet Patterns

by Michael Cao



Knot Monsters

Copyright © 2022 Michael Cao (@KnotMonster), Photography © 2022 Sushi Aquino

All rights reserved. All rights reserved. No part of this publication may be reproduced, stored in a retrieval system or transmitted in any form or by any means without the prior written permission of the publisher and copyright owner.

The book is sold subject to the condition that all designs are copyright and are not for commercial reproduction without the permission of the designer and copyright owner.



**To those who build satisfaction with their hands
and happiness with their heart**



<i>Nothing is hard, only new</i>	1
Hook, yarn and sinker	3
How to crochet	7
Peas in a pod	18
Corn	21
Green Onion/Scallion	24
Chili Pepper	26
“Spud” the Potato	28
Garlic	30
Beet	32
Carrot	34
Lettuce/Cabbage	35
Cauliflower	37
Broccoli	39
Bell Pepper	40
Sweet Onion	43
Mini Pumpkin	45
Eggplant	48
Turnip	50
Pickle	51
Mushroom Basket	53
Butternut Squash	56
Zucchini	57
Basket	59
Tote Bag	61

Knot Monsters

Banana	62
Apple	64
Pear	66
Orange	68
Lemon	70
Lime	71
Blueberry	72
Raspberry	73
Cherry	75
Strawberry	76
Grapes	78
Plum	80
Tomato	82
Tomato/Strawberry Pin Cushion	83
Avocado	85
Mini Watermelon	87
Watermelon Slice & Wedge	88
Kiwi	91
Mango	92
Peach	93
Grapefruit	95
Pineapple	96
Pomegranate	98
Mixed Nuts	99
Persimmon	101

Knot Monsters



What started as something to pass the time during quarantine has turned into so much more. These toys bring me joy when I make them and even more when I give them away. I hope that my creations will bring you and your lucky loved ones hours of happiness as well. I want to give a special thanks to *YOU* for making my creations and bringing them to life. Your continued support encourages my creative side.

THANK YOU



©knotmonsters.com

NOTHING IS HARD, ONLY NEW

If you have never crocheted before, **NO PROBLEM**. Everyone has to start somewhere. When I first started, it took me a week just to figure out how to make a ball. It took even longer to get my fingers and hands used to holding a crochet hook. Crocheting can be frustrating at first but like with all things new, your body will develop muscle memory and over time, you will find that it will get easier. Always remember that nothing is hard, only new. There is no right way or wrong way to crochet. Whatever works for you, your body, and your ability is the right way. Some people will hold a crochet hook like a pen, I prefer to hold it like a knife, with my index finger along the length of the hook. This is purely personal preference. Crochet is an art form and like all art forms, is open to personal interpretation. Crochet patterns function as guidelines only, and I encourage you to bring your own artistic flair to each pattern. Do not be afraid to use different hooks or types of yarn. Experiment by changing the colors. Add accessories, modify the body shape, and bring your own individual spice to each pattern. Sometimes it will work; most of the time, it will not, and that is perfectly fine because in the end, you will end up with something that is yours. Something that you created. Your own little knotmonster.



HOOK, YARN, AND SINKER

Crocheting requires two fundamental things: a hook and yarn. Hook sizes are measured in millimeters and are also given a corresponding letter. For example, a 3.75mm hook is called an “F” hook and a 4mm hook is called a “G” hook. For amigurumi, I like to use a 3.75mm or a 4mm hook with worsted weight yarn. The smaller the hook, the tighter the stitches will be; the bigger the hook, the looser the stitches will be. The yarn is complementary to the hook. A thinner yarn will require a smaller hook, and a thicker yarn will require a larger one. Let’s talk about what else you will need.

To start, you will need:

Hook [3.75mm (F) or 4mm (G)]

Yarn (worsted weight)

Scissors

Stitch marker (eg. scrap yarn, paper clip)

Safety eyes (8-14 mm)

Yarn needle #16 with blunt tip

Stuffing material

Pen/paper



Knot Monsters

Additional items:

Ruler

Hot glue or fabric glue

Felt (multiple colors)

Embroidery thread

Fabric scissors are specifically designed to cut fabric. They are incredibly sharp and will cut the yarn without fraying of the ends. This makes it much easier to thread the yarn through the needle when you are tying off.

Safety eyes are called “safety” because they have a small hole in the bottom of the eye. If a small child accidentally aspirates the eye, this hole will allow for air to pass through it. This is the concept, but it is not fool proof. Always use caution when you are giving a toy to a child under the age of three or to a child who tends to put things in their mouth. Alternatively, for these children, I would highly recommend making eyes out of yarn or felt instead. It is also important to thoroughly tie in your loose ends so your toys will not unravel and fall apart.

Stitch markers can be purchased from any craft store or online. Stitch markers help you keep track of where your first stitch in a row is. By marking your first stitch with a stitch marker, you will know when you have reached the end of your row. Alternatively, you can use a paper clip or a piece of scrap yarn (my personal favorite).



You want a needle that is wide enough to allow for worsted weight yarn to pass through the eye, while small enough to comfortably weave in your ends when you finish. A trick to easily thread your needle is to flatten the end of the yarn.

Accessories and pieces can be sewn or glued to your knotmonsters. Whenever possible, sew the pieces on, as they will hold much better than glue. However, glue works great to attach felt eyes as long as they are thoroughly attached, including the edges. When sewing, I recommend using the mattress stitch technique in order to hide the stitch as much as possible. For a mattress stitch, draw the yarn up one stitch and back down through the next stitch on the same piece. Then attach it to the other piece and repeat



HOW TO CROCHET

When you start a new pattern, the technique of crocheting will be noted as either completed in the straight or the round. Straight crocheting is completed in rows by going to the end of a row and turning around, creating a square-like pattern. Round crocheting is completed in rounds and, starting at the center, is done in spirals creating a circular pattern. Typically, a chain is used to start a straight crochet while a magic ring is used to start a round crochet. Exceptions to this are when an oval shape is desired. In this situation, you may form a chain and then, instead of turning at the end of the row, continuing onwards to the opposite side of the chain, thus creating an oval.

Patterns are written in different ways around the world. For example, in a UK pattern, a double crochet can mean a single crochet in a US pattern. For the sake of simplicity, all my patterns are based in US format and I have done my best to make them as simple and easy to read as possible. Each row/round is delineated

by “R1, R2, R3, etc.” When crocheting in the straight, at the end of each row, chain 1, turn the piece and start on the next row in the second chain from your hook. This step is necessary to create height in the piece. When crocheting in the round, one round means that you have crocheted completely around and have returned to the first stitch that you placed from the previous round. No chain/turning is necessary when crocheting in the round using any of my patterns because we will be working in a spiral motion. At the end of each row/round you will see a (#). This number represents how many stitches you should end up with when you finish the row/round.

Let’s do an example: “R3: (SC, inc) x 6 (18)”

This means that we are on round number three, and we will do a single crochet and then an increase; and then repeat that five more times. At the end of our round, we will end up with eighteen total stitches.

Difficulty is rated by easy, medium, or advanced, based on the number of unique stitch techniques in each pattern.

While standard crochet will work just fine for amigurumi patterns, I use cross stitching for all my amigurumi. Cross stitching tightens up the stitches and helps prevent the stuffing from showing and the stitches from stretching. It also makes a neat grid-like texture. Therefore, the following tutorials are for cross stitching and not standard crochet. If you are familiar with crocheting and notice that these instructions are backwards by yarning over instead of under, it is because of cross

stitching. The patterns will look perfectly adorable if you decide to not use cross stitching.

Slipknot

A slip knot allows you to tighten the knot with the loose yarn end. To create a slipknot, pull a loop made of the loose yarn end through the top of the first loop and tighten the knot. Pull on the loose yarn end to tighten the loop.



Chain (ch)

Start with your hook around a slipknot. Yarn over (yarn is over the hook) and pull through. You have made one chain or “ch 1.” To create multiple chains, continue yarning over until desired chain # is met.

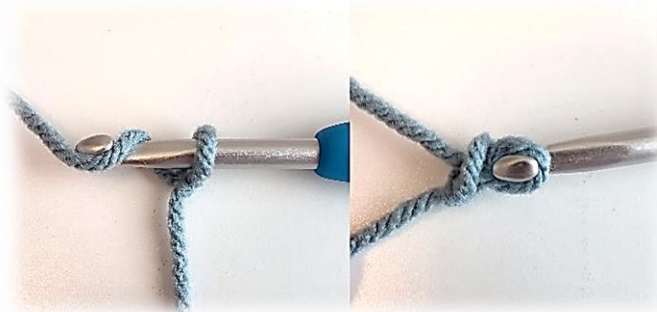

Slip Stitch (sl)

Enter next stitch with hook. Yarn under (yarn is under the hook – note this is for cross stitch) and pull through both loops. When you get to future rows, for sl, SC, DC, and TC, be sure to insert your hook under both loops when you start.



Single Crochet (SC)

Enter next stitch with hook. Yarn under (yarn is under the hook – note this is for cross stitch) and pull through first loop. Yarn over, pull through both loops.

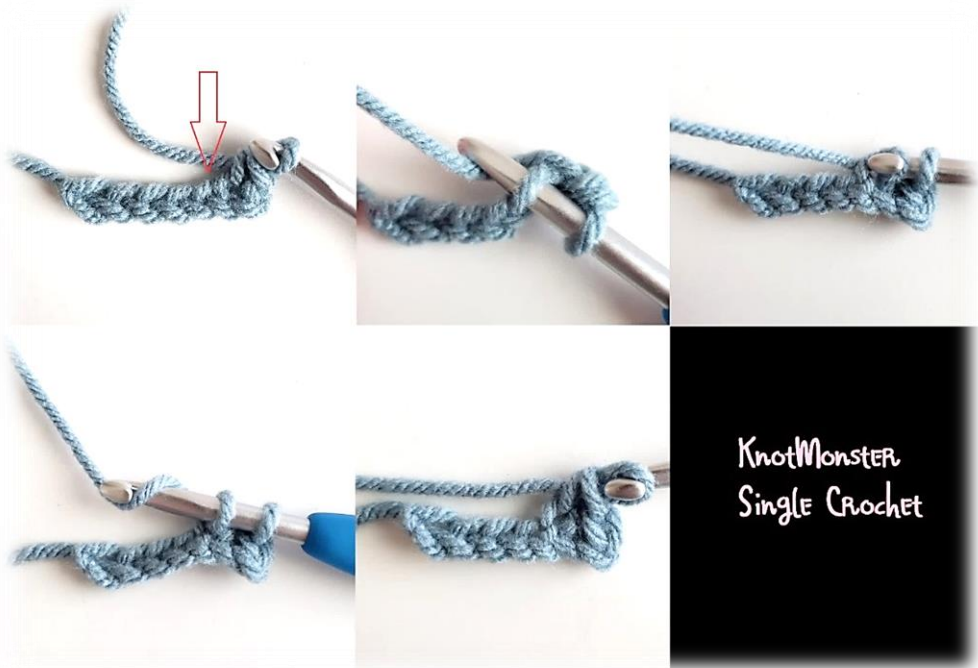

Half Double Crochet (HDC)

Yarn over, enter next stitch with hook. Yarn under (yarn is under the hook – note this is for cross stitch) and pull through all three loops.



Double Crochet (DC)

Yarn over, enter next stitch with hook. Yarn under (yarn is under the hook – note this is for cross stitch) and pull through first two loops. Yarn over and pull through last two loops.



Triple Crochet (TC)

Yarn over twice, enter next stitch with hook. Yarn under (yarn is under the hook – note this is for cross stitch) and pull through first two loops. Yarn over and pull through next two loops. Yarn over and pull through last two loops.

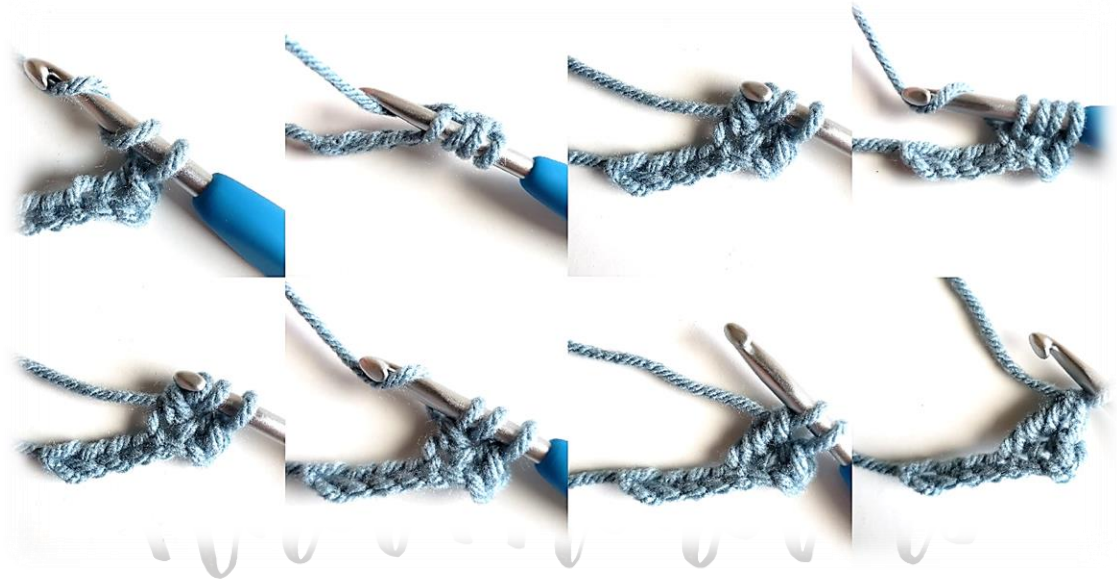

Increase (inc)

Single crochet twice in the same stitch.

Invisible Decrease (dec)

While not completely invisible and the name may suggest, the goal of an invisible decrease is to reduce the number of stitches in a row while creating minimal seams. This is done by inserting the hook into the next stitch. Then insert the hook into the following stitch. These stitches will be the front loops facing you on subsequent rows. Yarn under (note this is for cross stitch) and pull through first two loops. Then yarn over and pull through both loops.



Magic Ring

Position fingers and yarn as shown in (1), grab yarn from underneath loose end (2), twist (3), yarn over (4), pull through (5). You will not have a slipknot on a loop, so if you pull on the loose end the loop will close. Single crochet six times into the ring (9) and tighten up the loop (10). This will create a magic ring 6 (MR 6) which is the most common start to most amigurumi.



Front loops only (FLO) & Back loops only (BLO)

When a pattern calls for FLO or BLO, this means that you will be doing the next row in the back or the front loops only. If the next row does not indicate FLO/BLO, then switch back to normal crochet under both loops. Back and front is relative to you, so if the loop is facing you then that is the front loop and vice versa.



To change colors, when you reach the next row, draw up the new color through both loops and then single crochet into the next stitch. Tie both loose ends together in the back of the project.



Puff Stitch

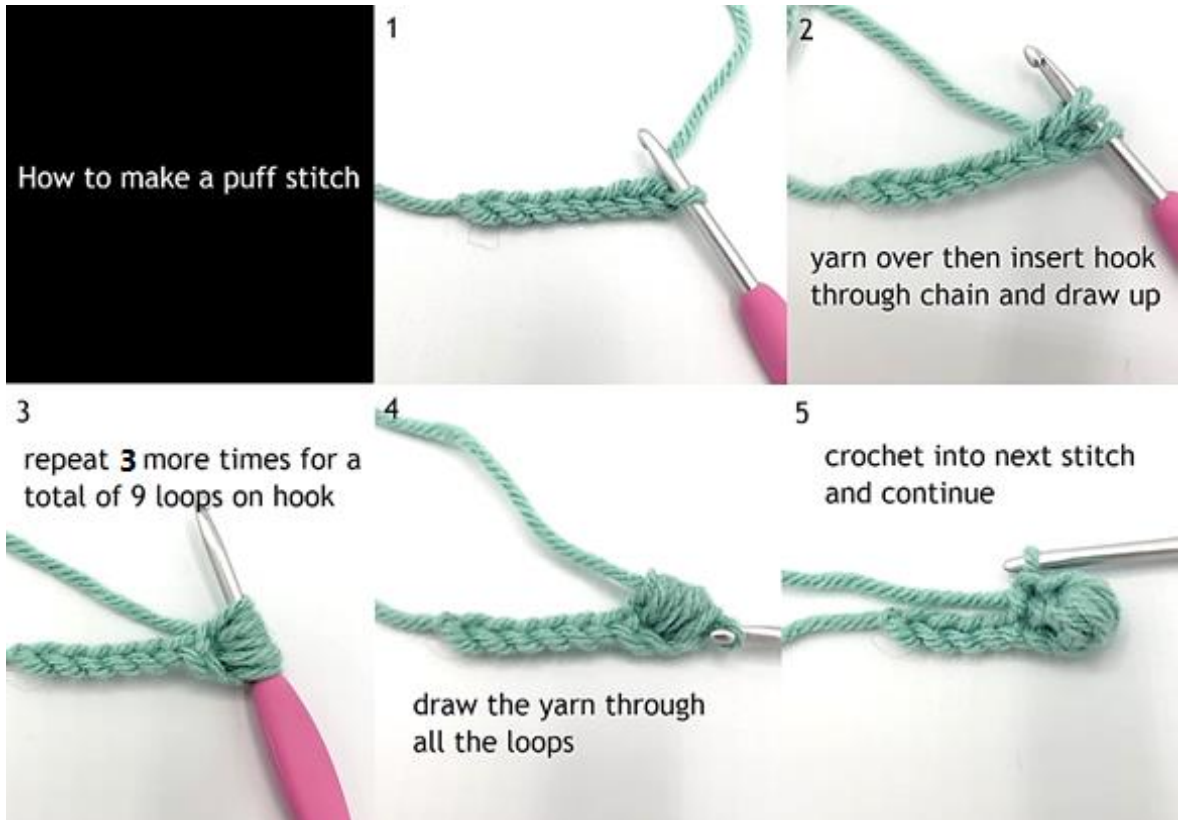

Oval Shape

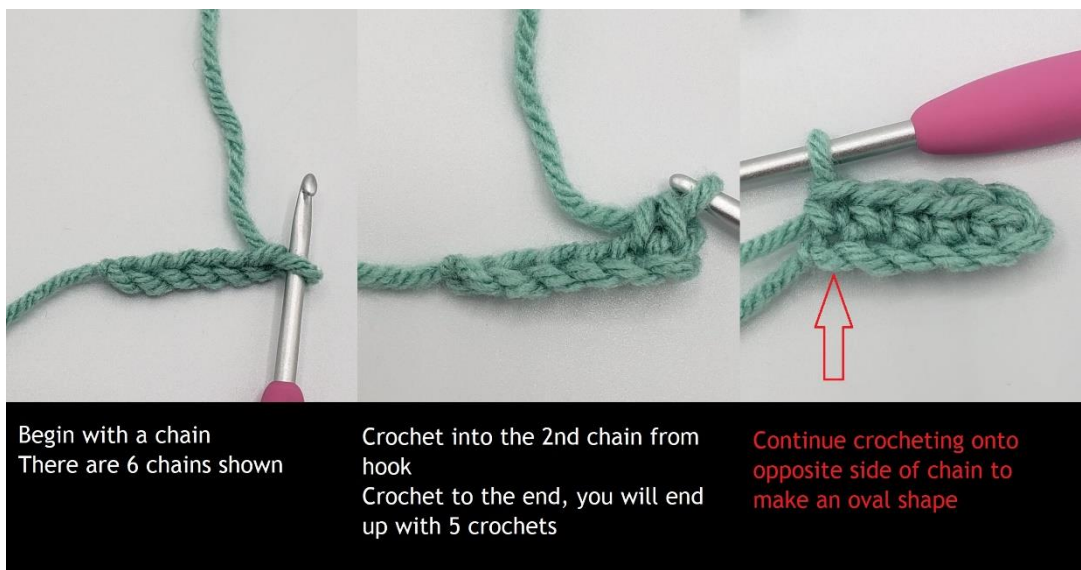

Attaching two feet together

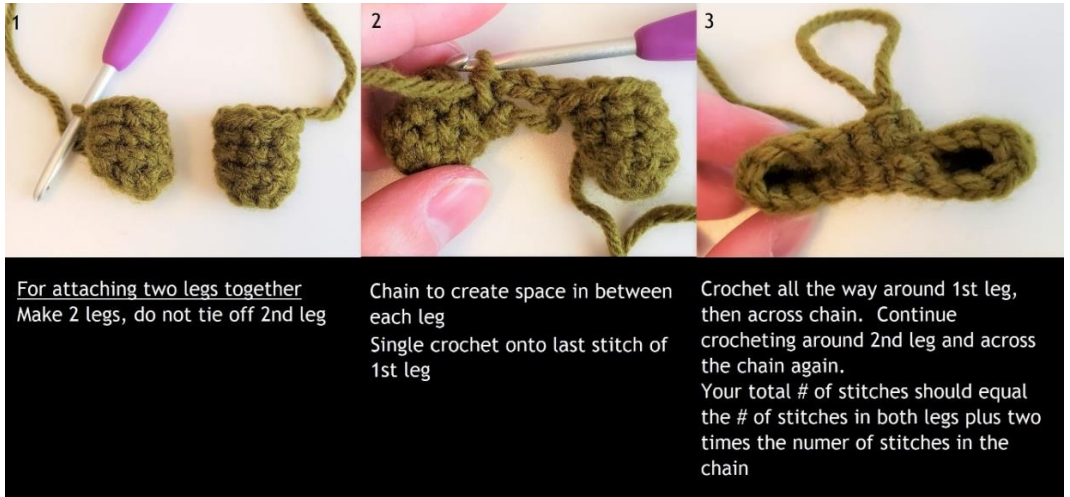

Tying off

When you reach the end of your project. To tie off, slip stitch into the next stitch, then chain one. Pull the yarn all the way through, leaving a long end for sewing and cut the yarn where the red arrow is. Thread the yarn through a #16 yarn needle and weave it through several nearby stitches. Do this in three separate directions and then pass the yarn through the project and cut the yarn to hide the loose end.





R9: (SC 3, dec) x 6 (24)

R10: (SC 2, dec) x 6 (18)

Attach eyes. Use embroidery thread for mouth and cheeks.

Stuff

R11: (SC, dec) x 6 (12)

R12: dec x 6 (6)

Tie off

Peas in a Pod

Difficulty: Medium

Hook: 4.0mm (G) or 3.75 mm (F) hook

Approximate size: 13cm x 5cm

Eye: 6 mm

All rows completed in the round unless otherwise indicated

PEAS (make 2)

Start with color light green

R1: MR 6 (6)

R2: inc x 6 (12)

R3: (SC, inc) x 6 (18)

R4: (SC 2, inc) x 6 (24)

R5: (SC 3, inc) x 6 (30)

R6-8: SC 30 (30)



We go together like
two peas in a pod ♡

COVER

Start with color green

Ch 11, turn and begin in 2nd
chain from hook

R1: SC 9, inc, continue onto
other side of chain, SC 9, inc (22)

R2: inc, SC 8, inc x 3, SC 8, inc x
2 (28)

R3: SC, inc, SC 8, (SC, inc) x 3,
SC 8, (SC, inc) x 2 (34)

R4: SC 2, inc, SC 8, (SC 2, inc) x
3, SC 8, (SC 2, inc) x 2 (40)

R5: SC 3, inc, SC 8, (SC 3, inc) x
3, SC 8, (SC 3, inc) x 2 (46)

R6: SC 4, inc, SC 8, (SC 4, inc) x
3, SC 8, (SC 4, inc) x 2 (52)

R7-12: SC 52 (52)

Tie off

Sew corners together to create a
pinch on the edges



STEM

Part 1

Start with color dark green

Ch 11, turn and begin in 2nd chain from hook
chain from hook

R1: SC, HDC, DC, HDC, sl, sl,
HDC, DC, HDC, SC continue
onto other side of chain, SC,
HDC, DC, HDC, sl, sl, HDC,
DC, HDC, SC (20)

Tie off, set aside



Part 2

Start with color dark green

R1: MR 4 (4)

R2-4: SC 4 (4)

Tie off, attach to center of part 1
and attach to cover



Knot Monsters



Corn

Difficulty: Easy

Hook: 4.0mm (G) or 3.75 mm (F)
hook

Approximate size: 13cm x 7cm

Eye: 6 mm

All rows completed in the round
unless otherwise indicated

BODY

Start with color yellow

R1: MR 6 (6)

R2: inc x 6 (12)

R3: (SC, inc) x 6 (18)

R4: (SC 2, inc) x 6 (24)

R5: (SC 3, inc) x 6 (30)

R6-25: SC 30 (30)

Insert eyes between rounds 16 and 17, four stitches apart. Use embroidery thread for mouth and cheeks.

Begin stuffing

R26: (SC 3, dec) x 6 (24)

R27: SC 24 (24)

R28: (SC 2, dec) x 6 (18)

R29: SC 18 (18)

R30: (SC, dec) x 6 (12)

R31: SC 12 (12)

Finish stuffing

R32: dec x 6 (6)

Tie off

Not to sound corny...
but you're A-maize-ing



HUSK

Start with color green

R1: MR 6 (6)

R2: inc x 6 (12)

R3: BLO SC 12 (12)

R4: (HDC, HDC inc) x 6 (18)
~HDC inc = 2 HDC's in one stitch

R5: (HDC 2, HDC inc) x 6 (24)

R6: (HDC 3, HDC inc) x 6 (30)

R7-9: HDC 30 (30)

The remainder of the pattern will be crocheted in the straight

At the end of each row, ch 1, and begin next row in 2nd stitch from hook

Ch 1, turn

R10: HDC 30 (30)

R11: dec, HDC 26, dec (28)

R12: dec, HDC 24, dec (26)

R13: dec, HDC 22, dec (24)

R14: dec, HDC 20, dec (22)

R15: dec, HDC 18, dec (20)

R16: dec, HDC 16, dec (18)

R17: dec, HDC 14, dec (16)

R18: dec, HDC 12, dec (14)

R19: dec, HDC 10, dec (12)

R20: dec, HDC 8, dec (10)

R21: dec, HDC 6, dec (8)

R22: dec, HDC 4, dec (6)

R23: dec, HDC 2, dec (4)

R24: dec x 2 (2)

R25: dec (1)

Tie off



Using cream colored yarn, tie several strands to tip of husk.

Place body inside husk and sew together if desired.



Monsters



GREEN Onion/Scallion

Difficulty: Easy

Hook: 4.0mm (G) or 3.75 mm (F) hook

Approximate size: 25cm x 5cm

Eye: 6 mm

All rows completed in the round unless otherwise indicated

BODY

Start with color white

R1: MR 6 (6)

R2: inc x 6 (12)

R3: (SC, inc) x 6 (18)

R4: (SC 2, inc) x 6 (24)

R5-7: SC 24 (24)

R8: (SC 4, dec) x 4 (20)

R9: SC 20 (20)

R10: (SC 3, dec) x 4 (16)

R11: SC 16 (16)

Attach eyes, use embroidery thread for mouth and cheeks

Stuff

R12: dec x 8 (8)

R13-14: SC 8 (8)

Change color to light green

R15-17: SC 8 (8)

Switch color to dark green

R18: SC 8 (8)

R19: (dec, SC 2) x 2 (6)

Tie off

Using single strands of tan colored yarn, sew several strands of varying length to the bottom of body. You can unravel the yarn to create a more root-like appearance



ENDS

Part 1

Start with color dark green

R1: MR (4)

R2-21: SC 4 (4)

Tie off, attach to body



Part 2

Start with color dark green

R1: MR (4)

R2-16: SC 4 (4)

Tie off, attach to body

Knot Monsters

Part 3

Start with color dark green

R1: MR (4)

R2-18: SC 4 (4)

Tie off, attach to body

Health Benefits

- ✓ Sodium-Free
- ✓ Sugar-Free
- ✓ Cholesterol-Free
- ✓ Will be there for you when you cry



Chili Pepper

Difficulty: Easy

Hook: 4.0mm (G) or 3.75 mm (F) hook

Approximate size: 15cm x 6cm

Eye: 6 mm

All rows completed in the round unless otherwise indicated

BODY

Start with color red

R1: MR 6 (6)

R2: inc x 6 (12)

R3: (SC, inc) x 6 (18)

R4: (SC 2, inc) x 6 (24)

R5: (SC 3, inc) x 6 (30)

R6-8: SC 30 (30)

R9: dec, SC 28 (29)

R10: dec, SC 27 (28)

R11: dec, SC 26 (27)

R12: dec, SC 25 (26)

R13: dec, SC 24 (25)

R14: dec, SC 23 (24)

R15: dec, SC 22 (23)

Attach eyes, use embroidery thread for mouth and cheeks

R16: dec, SC 21 (22)

R17: dec, SC 20 (21)

R18: dec, SC 19 (20)

Stuff

R19: dec, SC 18 (19)

R20: dec, SC 17 (18)

R21: SC 8, dec, SC 8 (17)

R22: SC 8, dec, SC 7 (16)

R23: SC 7, dec, SC 7 (15)

R24: SC 7, dec, SC 6 (14)

R25: SC 6, dec, SC 6 (13)

Stuff

R26: SC 6, dec, SC 5 (12)

R27: SC 5, dec, SC 5 (11)

R28: SC 5, dec, SC 4 (10)

R29: SC 4, dec, SC 4 (9)

Stuff

R30: SC 4, dec, SC 3 (8)

R31: SC 3, dec, SC 3 (7)

Finish stuffing

R32: SC 3, dec, SC 2 (6)

R33: SC 2, dec, SC 2 (5)

R34: SC 2, dec, SC (4)

Tie off

STEM

Start with color green

R1: MR 5 (5)

R2-6: SC 5 (5)

R7: FLO inc x 5 (10)

R8: (SC, inc) x 5 (15)

R9: (SC 2, inc) x 5 (20)

R10: (SC, DC, TC, DC) x 5 (20)

Tie off, no need to stuff, attach to body





“Spud” the Potato

Difficulty: Easy

Hook: 4.0mm (G) or 3.75 mm (F) hook

Approximate size: 10cm x 8cm

Eye: 6 mm

All rows completed in the round unless otherwise indicated

BODY

Start with color light brown

R1: MR 6 (6)

R2: inc x 6 (12)

R3: (SC, inc) x 6 (18)

R4: (SC 2, inc) x 6 (24)

R5: (SC 3, inc) x 6 (30)

R6: (SC 4, inc) x 6 (36)

R7: (SC 5, inc) x 6 (42)

R8-22: SC 42 (42)

Attach eyes, use embroidery thread for mouth and cheeks

R23: (SC 5, dec) x 6 (36)

R24: (SC 4, dec) x 6 (30)

R25: (SC 3, dec) x 6 (24)

Stuff

R26: (SC 2, dec) x 6 (18)

R27: (SC, dec) x 6 (12)

R28: dec x 6 (6)

Tie off



Taters gonna Tate
 \(\odot\)/

Leave end long for making indentations

To make indentations, run yarn through body and re-enter needle one stitch apart. Pull tightly to form indentation. Add as many as you like. Tie off when finished.



monsters



Garlic

Difficulty: Medium

Hook: 4.0mm (G) or 3.75 mm (F) hook

Approximate size: 10cm x 8cm

Eye: 6 mm

All rows completed in the round unless otherwise indicated

BODY

Start with color light brown

R1: MR 6 (6)

R2: SC 6 (6)

Change color to white

R3: inc x 6 (12)

R4: (SC, inc) x 6 (18)

R5: (SC 2, inc) x 6 (24)

R6: (SC 3, inc) x 6 (30)

R7: (SC 4, inc) x 6 (36)

R8: (SC 5, inc) x 6 (42)

R9-13: SC 42 (42)

R14: (SC 5, dec) x 6 (36)

R15: SC 36 (36)

R16: (SC 4, dec) x 6 (30)

R17: SC 30 (30)

R18: (SC 3, dec) x 6 (24)

Attach eyes, use embroidery thread for mouth and cheeks

Stuff

R19: (SC 2, dec) x 6 (18)

R20: (SC, dec) x 6 (12)

R21: dec x 6 (6)

R22-23: SC 6 (6)

Tie off, *leave end very long*

-Using the long end, thread yarn needle through bottom of body (between rounds 2 and 3) and out through top of body (between round 17 and 18). Pull to compress top and bottom of body. Bring needle back up and thread through entire body again. Repeat this a total of 6 times to create shape of garlic.



©knotmonsters.com



©knotmonsters.com



m



©knotmonsters.com

What did the garlic do when it got hot?
It took all its CLOVES off

LEAF (make 3)

Start with color light green

Ch 7, turn and begin in 2nd chain from hook, sl 6

Tie off and attach to top of body



©knotmonsters.com



©knotmonsters.com



Beet

Difficulty: Medium

Hook: 4.0mm (G) or 3.75 mm (F) hook

Approximate size: 15cm x 8cm

Eye: 6 mm

All rows completed in the round unless otherwise indicated

BODY

Start with color purple

R1: MR 6 (6)

R2: inc x 6 (12)

R3: (SC, inc) x 6 (18)

R4: (SC 2, inc) x 6 (24)

R5: (SC 3, inc) x 6 (30)

R6: (SC 4, inc) x 6 (36)

R7: (SC 5, inc) x 6 (42)

R8-11: SC 42 (42)

R12: (SC 5, dec) x 6 (36)

R13: (SC 4, dec) x 6 (30)

Attach eyes, use embroidery thread for mouth and cheeks

R14: (SC 3, dec) x 6 (24)

R15: SC 24 (24)

R16: (SC 2, dec) x 6 (18)

R17: SC 18 (18)

Stuff

R18: (SC, dec) x 6 (12)

R19: SC 12 (12)

R20: dec x 6 (6)

R21: SC 6 (6)

R22: (SC, dec) x 2 (4)

Tie off



♪ Let the beet drop ♪

LEAVES (make 3)

Crocheted in the straight

Start with color purple

Ch 16, turn and begin in 2nd chain from hook

Change color to green

R1: SC 15, continue onto other side of chain SC 15

Ch 1, turn and begin in 2nd chain from hook

R2: sl 2, SC 2, HDC 2, (2 HDC's in 1 st) x 2, DC, (2 DC's in 1 st) x 2, TC, (2 TC's in 1 st) x 6, TC, (2 DC's in 1 st) x 2, DC, (2 HDC's in 1 st) x 2, HDC 2, SC 2, sl 2

Tie off, attach to body



Knot Monsters



Carrot

Difficulty: Easy

Hook: 4.0mm (G) or 3.75 mm (F) hook

Approximate size: 10cm x 6cm

Eye: 6 mm

All rows completed in the round unless otherwise indicated

BODY

Start with color orange

R1: MR 6 (6)

R2: inc x 6 (12)

R3: (SC, inc) x 6 (18)

R4: (SC 2, inc) x 6 (24)

R5: (SC 3, inc) x 6 (30)

R6-7: SC 30 (30)

R8: (SC 8, dec) x 3 (27)

R9-10: SC 27 (27)

R11: (SC 7, dec) x 3 (24)

R12-13: SC 24 (24)

Attach eyes. Use embroidery thread for mouth and cheeks.

R14: (SC 6, dec) x 3 (21)

R15-16: SC 21 (21)

R17: (SC 5, dec) x 3 (18)

R18-19: SC 18 (18)

Stuff

R20: (SC 4, dec) x 3 (15)

R21-22: SC 15 (15)

R23: (SC 3, dec) x 3 (12)

Finish stuffing

R24: dec x 6 (6)

Tie off

TOP (make 3)

Start with color green

Ch 21, turn and begin in 2nd chain from hook

(3 SC's in 1 stitch) x 15, sl 5

Tie to body





Lettuce/Cabbage

Difficulty: Easy

Hook: 4.0mm (G) or 3.75 mm

(F) hook

Approximate size: 10cm x 10cm

Eye: 6 mm

All rows completed in the round
unless otherwise indicated

BODY

Start with color green

R1: MR 6 (6)

R2: inc x 6 (12)

R3: (SC, inc) x 6 (18)

R4: (SC 2, inc) x 6 (24)

R5: (SC 3, inc) x 6 (30)

R6: (SC 4, inc) x 6 (36)

R7-10: SC 36 (36)

R11: (SC 4, dec) x 6 (30)

Attach eyes. Use embroidery thread for mouth and cheeks.

R12: (SC 3, dec) x 6 (24)

R13: (SC 2, dec) x 6 (18)

Stuff

R14: (SC, dec) x 6 (12)

R15: dec x 6 (6)

Tie off



We don't know any
cabbage jokes, but
if you do.

Lettuce know

LEAVES

Part 1 (make 3)

Start with color green

R1: MR 6 (6)

R2: inc x 6 (12)

R3: (SC, inc) x 6 (18)

R4: (SC 2, inc) x 6 (24)

R5: (SC 3, inc) x 6 (30)

R6: (SC 4, inc) x 6 (36)

R7: (SC 5, inc) x 6 (42)

Tie off, attach in spiral around
body



Part 2 (make 3)

Start with color green

R1: MR 6 (6)

R2: inc x 6 (12)

R3: (SC, inc) x 6 (18)

R4: (SC 2, inc) x 6 (24)

R5: (SC 3, inc) x 6 (30)

R6: (SC 4, inc) x 6 (36)

R7: (SC 5, inc) x 6 (42)

R8: (SC 6, inc) x 6 (48)

Tie off, attach in spiral around
body





Cauliflower

Difficulty: Advanced

Hook: 4.0mm (G) or 3.75 mm (F) hook

Approximate size: 13cm x 8cm

Eye: 8 mm

All rows completed in the round unless otherwise indicated

BODY part 1

Start with color cream

R1: MR 6 (6)

R2: inc x 6 (12)

R3: (SC, inc) x 6 (18)

R4: (SC 2, inc) x 6 (24)

R5: (SC 3, inc) x 6 (30)

R6: (SC 4, inc) x 6 (36)

R7: BLO (SC 5, inc) x 6 (42)

R8: SC 42 (42)

R9-11: (SC, puff) x 21 (42)

R12: (puff, SC, puff, SC, puff, dec) x 6 (36)

R13: (SC, puff, SC, puff, dec) x 6 (30)

R14: (puff, SC, puff, dec) x 6 (24)

R15: (SC, puff, dec) x 6 (18)

Attach eyes. Use embroidery thread for mouth and cheeks.

Stuff

R16: (puff, dec) x 6 (12)

R17: dec x 6 (6)

Tie off



BODY part 2

Start with color light green

R1: MR 6 (6)

R2: inc x 6 (12)

R3: (SC, inc) x 6 (18)

R4: (SC 2, inc) x 6 (24)

R5: (SC 3, inc) x 6 (30)

R6: (SC 4, inc) x 6 (36)

R7: (SC 5, inc) x 6 (42)

R8: BLO (SC 6, inc) x 6 (48)

R9: (SC 7, inc) x 6 (54)

R10: SC 54 (54)

R11: HDC 54 (54)

**R12: (3 HDC's in one stitch) x 54
(162)**

Tie off and attach to body part 1



Knot Monsters

Why did the Bee buy
a phone?

To Cauliflower



Broccoli

Difficulty: Advanced

Hook: 4.0mm (G) or 3.75 mm (F)
hook

Approximate size: 10cm x 10cm

Eye: 8 mm

All rows completed in the round
unless otherwise indicated

BODY

Start with color light green

R1: MR 6 (6)

R2: inc x 6 (12)

R3: (SC, inc) x 6 (18)

R4: (SC 2, inc) x 6 (24)

R5: (SC 3, inc) x 6 (30)

R6: BLO SC 30 (30)

R7-16: SC 30 (30)

Change color to dark green

R17: FLO (inc, puff) x 15 (45)

R18-21: SC, (puff, SC) x 22 (45)

R22: puff, (SC, puff) x 6, dec,
puff, (SC, puff) x 6, dec, puff,
(SC, puff) x 6, dec (42)

R23: (puff, SC, puff, SC, puff,
dec) x 6 (36)

R24: (SC, puff, SC, puff, dec) x 6
(30)

Attach eyes. Use embroidery
thread for mouth and cheeks.

Stuff

R25: (puff, SC, puff, dec) x 6 (24)

R26: (SC, puff, dec) x 6 (18)

Finish stuffing

R27: (puff, dec) x 6 (12)

R28: dec x 6 (6)

Tie off





BELL PEPPER

Difficulty: Easy

Hook: 4.0mm (G) or 3.75 mm (F)
hook

Approximate size: 8cm x 8cm

Eye: 6 mm

All rows completed in the round
unless otherwise indicated

BODY

Start with color red

R1: MR 6 (6)

R2: inc x 6 (12)

R3: (SC, inc) x 6 (18)

R4: (SC 2, inc) x 6 (24)

R5: (SC 3, inc) x 6 (30)

R6: (SC 4, inc) x 6 (36)

R7: (SC 5, inc) x 6 (42)

R8-21: SC 42 (42)

Attach eyes, use embroidery
thread for mouth and cheeks

R22: (SC 5, dec) x 6 (36)

R23: (SC 4, dec) x 6 (30)

R24: (SC 3, dec) x 6 (24)

Stuff

R25: (SC 2, dec) x 6 (18)

R26: (SC, dec) x 6 (12)

R27: dec x 6 (6)

Tie off

Leave end very long

Using the long end, thread yarn
needle through top of body and
out through bottom of body.
Pull tightly to compress top and
bottom of body. Bring needle
back up and thread through
entire body again. Repeat this a
total of 4 times to create shape of
bell pepper.





STEM

Start with color green

R1: MR 6 (6)

R2: SC 6 (6)

R3: (SC, dec) x 2 (4)

R4-5: SC 4 (4)

R6: inc x 4 (8)

R7: inc x 8 (16)

Tie off, no need to stuff, attach
to body



Knot Monsters

Did you know bell
peppers are a great
source of Vitamin C
(aka Vitamin cute)?



Sweet Onion

Difficulty: Easy

Hook: 4.0mm (G) or 3.75 mm (F) hook

Approximate size: 10cm x 8cm

Eye: 6 mm

All rows completed in the round unless otherwise indicated

BODY

Start with color dark brown

R1: MR 6 (6)

Change color to light brown

R2: inc x 6 (12)

R3: (SC, inc) x 6 (18)

R4: (SC 2, inc) x 6 (24)

R5: (SC 3, inc) x 6 (30)

R6: (SC 4, inc) x 6 (36)

R7: (SC 5, inc) x 6 (42)

R8: (SC 6, inc) x 6 (48)

R9-14: SC 48 (48)

R15: (SC 6, dec) x 6 (42)

R16: (SC 5, dec) x 6 (36)

R17: (SC 4, dec) x 6 (30)

R18: (SC 3, dec) x 6 (24)

Attach eyes, use embroidery thread for mouth and cheeks

Stuff

R19: (SC 2, dec) x 6 (18)

R20: SC 18 (18)

R21: (SC, dec) x 6 (12)

R22: SC 12 (12)

R23: dec x 6 (6)

R24: SC 6 (6)

R25: (ch 2, sl into next stitch) x 6 (6)

Tie off



Using single strands of dark brown yarn, sew several strands of varying length to the bottom of body. You can unravel the yarn to create a more root-like appearance



Crying of happiness



Mini Pumpkin

Difficulty: Easy

Hook: 4.0mm (G) or 3.75 mm (F) hook

Approximate size: 12cm x 8cm

Eye: 6 mm

All rows completed in the round unless otherwise indicated

BODY

Start with color orange or gold

R1: MR 6 (6)

R2: inc x 6 (12)

R3: (SC, inc) x 6 (18)

R4: (SC 2, inc) x 6 (24)

R5: (SC 3, inc) x 6 (30)

R6: (SC 4, inc) x 6 (36)

R7: (SC 5, inc) x 6 (42)

R8: (SC 6, inc) x 6 (48)

R9: (SC 7, inc) x 6 (54)

R10: (SC 8, inc) x 6 (60)

R11-17: SC 60 (60)

R18: (SC 8, dec) x 6 (54)

R19: (SC 7, dec) x 6 (48)

R20: (SC 6, dec) x 6 (42)

R21: (SC 5, dec) x 6 (36)

Attach eyes, use embroidery thread for mouth and cheeks

R22: (SC 4, dec) x 6 (30)

R23: (SC 3, dec) x 6 (24)

Stuff

R24: (SC 2, dec) x 6 (18)

R25: (SC, dec) x 6 (12)

R26: dec x 6 (6)

Change color to green

When you are changing colors leave end of orange/gold yarn very long -thread end through bottom of body and then continue with pattern.

R27-32: SC 6 (6)

Tie off



Using the long end, thread yarn needle through bottom of body and out through top of body. Pull tightly to compress top and bottom of body. Bring needle back up and thread through entire body again. Repeat this a total of 6 times to create shape of pumpkin.



What do you call
a big pumpkin?
A plumpkin



LEAF

Start with color light green

Ch 8, turn and begin in 2nd chain from hook

R1: sl, SC, 4 HDC, SC, continue onto other side of chain, SC, 4 HDC, SC, sl (14)

Slip back into 1st stitch in R1

Tie off, leave end long for attaching to stem. Attach to stem.



Optional Curly Leaf:

Ch 15, turn, starting in 2nd chain from hook, inc x 14, tie off and attach to stem

Knot Monsters



Eggplant

Difficulty: Medium

Hook: 4.0mm (G) or 3.75 mm (F)
hook

Approximate size: 18cm x 10cm

Eye: 6 mm

All rows completed in the round
unless otherwise indicated

BODY

Start with color purple

R1: MR 6 (6)

R2: inc x 6 (12)

R3: (SC, inc) x 6 (18)

R4: (SC 2, inc) x 6 (24)

R5: (SC 3, inc) x 6 (30)

R6: (SC 4, inc) x 6 (36)

R7: (SC 5, inc) x 6 (42)

R8: (SC 6, inc) x 6 (48)

R9-18: SC 48 (48)

R19: (SC 6, dec) x 6 (42)

R20: dec, SC 40 (41)

R21: dec, SC 39 (40)

Attach eyes, use embroidery
thread for mouth and cheeks

R22: dec, SC 38 (39)

R23: dec, SC 37 (38)

R24: dec, SC 36 (37)

R25: dec, SC 35 (36)

R26: dec, SC 34 (35)

R27: dec, SC 33 (34)

R28: dec, SC 32 (33)

R29: dec, SC 31 (32)

R30: dec, SC 30 (31)

R31: dec, SC 29 (30)

R32-34: SC 30 (30)

R35: (SC 3, dec) x 6 (24)

Stuff

R36: (SC 2, dec) x 6 (18)

R37: (SC, dec) x 6 (12)

R38: dec x 6 (6)

Tie off

You're an
aubergenius



STEM

Start with color green

R1: MR 6 (6)

R2-6: SC 6 (6)

R7: inc x 6 (12)

R8: (SC, inc) x 6 (18)

R9: (SC 2, inc) x 6 (24)

R10: (SC, ch 4, starting in 2nd chain from hook: "HDC, DC, TC down chain", skip 2 stitches) x 6, sl into first stitch

Tie off, no need to stuff, attach to body





Turnip

Difficulty: Medium

Hook: 4.0mm (G) or 3.75 mm (F) hook

Approximate size: 14cm x 7cm

Eye: 6 mm

All rows completed in the round unless otherwise indicated

BODY

Start with color white

R1: MR 6 (6)

R2: inc x 6 (12)

R3: (SC, inc) x 6 (18)

R4: (SC 2, inc) x 6 (24)

R5: (SC 3, inc) x 6 (30)

R6: (SC 4, inc) x 6 (36)

R7: (SC 5, inc) x 6 (42)

R8-12: SC 42 (42)

R13: (SC 5, dec) x 6 (36)

R14: (SC 4, dec) x 6 (30)

Attach eyes, use embroidery thread for mouth and cheeks

R15: (SC 3, dec) x 6 (24)

R16: (SC 2, dec) x 6 (18)

R17: SC 18 (18)

Stuff

R18: (SC, dec) x 6 (12)

R19: SC 12 (12)

R20: dec x 6 (6)

Tie off

Lost something?
Don't worry, it'll
turnip



LEAVES (make 2)

Crocheted in the straight

Start with color green

Ch 13, turn and begin in 2nd chain from hook

R1: sl 3, HDC, DC, HDC, sl, HDC, DC, (2 DC's in 1 st) x 3, continue onto other side of chain, (2 DC's in 1 st) x 3, DC, HDC, sl, HDC, DC, HDC, sl 3

Tie off, attach to body





Pickle Cucumber

Difficulty: Medium

Hook: 4.0mm (G) or 3.75 mm (F)
hook

Approximate size: 15cm x 5cm

Eye: 6 mm

All rows completed in the round
unless otherwise indicated

BODY

Start with color green

R1: MR 6 (6)

R2: inc x 6 (12)

R3: (SC, inc) x 6 (18)

R4: (SC 2, inc) x 6 (24)

R5: (SC 3, inc) x 6 (30)

R6: SC 30 (30)

R7: dec, SC 13, inc, SC 8, puff,
SC 5 (30)

R8: SC 30 (30)

R9: dec, SC 5, puff, SC 7, inc, SC
14 (30)

R10: SC 30 (30)

R11: dec, SC 14, puff, inc, SC 12
(30)

R12: SC 30 (30)

R13: dec, puff, SC 13, inc, SC 13
(30)

R14: SC 30 (30)

R15: dec, SC 15, inc, SC 2, puff,
SC 9 (30)

R16: SC 30 (30)

R17: dec, SC 7, puff, SC 5, inc,
SC 14 (30)

R18: SC 30 (30)

R19: dec, SC 13, inc, SC 9, puff,
SC 4 (30)

R20: SC 30 (30)

Attach eyes. Use embroidery
thread for mouth and cheeks.

Begin stuffing

R21: inc, SC 2, puff, SC 10, dec,
SC 14 (30)

R22: SC 30 (30)

R23: inc, SC 13, dec, puff, SC 13
(30)

R24: SC 30 (30)

R25: inc, SC 15, dec, SC 4, puff,
SC 8 (30)

R26: SC 30 (30)

R27: inc, puff, SC 13, dec, SC 13
(30)

R28: SC 30 (30)

R29: inc, SC 12, puff, SC, dec, SC
13 (30)

R30: SC 30 (30)

Stuff

R31: inc, SC 14, dec, SC 11, puff,
SC (30)

R32: SC 30 (30)

R33: (SC 3, dec) x 6 (24)

R34: (SC 2, dec) x 6 (18)

Finish stuffing

R35: (SC, dec) x 6 (12)

R36: dec x 6 (6)

Tie off

Knot Monsters



Stuff

Change color to white

R9: BLO SC 12 (12)

R10-11: SC 12 (12)

Stuff

R12: BLO dec x 6 (6)

Tie off



Mushroom basket

Difficulty: Easy

Hook: 4.0mm (G) or 3.75 mm (F)
hook

Approximate size: 5cm x 5cm

All rows completed in the round
unless otherwise indicated

VERSION 1

Start with color white

R1: MR 6 (6)

R2: inc x 6 (12)

R3: (SC, inc) x 6 (18)

R4: (SC 2, inc) x 6 (24)

R5-6: SC 24 (24)

Change color to dark brown

R7: BLO (SC 2, dec) x 6 (18)

R8: (SC, dec) x 6 (12)



VERSION 2

Start with color dark brown

R1: MR 6 (6)

R2: SC 6 (6)

R3: inc x 6 (12)

R4: SC 12 (12)

R5: (SC, inc) x 6 (18)

R6: SC 18 (18)

Change color to light brown

R7: BLO (SC, dec) x 6 (12)

Stuff

R8: BLO dec x 6 (6)

R9: FLO SC 6 (6)

R10: (SC 2, inc) x 2 (8)

R11-12: SC 8 (8)

Stuff

R13: (SC 2, dec) x 2 (6)

Tie off



VERSION 3

Start with color dark brown

R1: MR 6 (6)

R2: SC 6 (6)

R3: inc x 6 (12)

R4: SC 12 (12)

R5: (SC, inc) x 6 (18)

R6: (SC 2, inc) x 6 (24)

R7: (SC 3, inc) x 6 (30)

R8: (SC 4, inc) x 6 (36)

R9: BLO (SC 4, dec) x 6 (30)

Change color to light brown

R10: (SC 3, dec) x 6 (24)

R11: (SC 2, dec) x 6 (18)

R12: (SC, dec) x 6 (12)

R13: dec x 6 (6)

R14: FLO SC 6 (6)

R15-22: SC 6 (6)

Tie off, no need to stuff



POT

Start with color tan

“(3 HDC’s) = (3 half double crochets in 1 stitch)”

R1: 8 HDC’s in a magic ring (8)

R2: [(3 HDC’s), HDC] x 4 (16)

R3: [(3 HDC’s), HDC 3] x 4 (24)

R4: [(3 HDC’s), HDC 5] x 4 (32)

R5: [(3 HDC’s), HDC 7] x 4 (40)

R6: [(3 HDC’s), HDC 9] x 4 (48)

R7: BLO HDC 48 (48)

R8-12: HDC 48 (48)

Tie off, attach face if desired



There is so
mushroom in my
heart for you



Butternut Squash

Difficulty: Easy

Hook: 4.0mm (G) or 3.75 mm (F) hook

Approximate size: 14cm x 10cm

Eye: 8 mm

All rows completed in the round unless otherwise indicated

BODY

Start with color tan

R1: MR 6 (6)

R2: inc x 6 (12)

R3: (SC, inc) x 6 (18)

R4: (SC 2, inc) x 6 (24)

R5: (SC 3, inc) x 6 (30)

R6: (SC 4, inc) x 6 (36)

R7: (SC 5, inc) x 6 (42)

R8: (SC 6, inc) x 6 (48)

R9: (SC 7, inc) x 6 (54)

R10-15: SC 54 (54)

R16: (SC 7, dec) x 6 (48)

R17: (SC 6, dec) x 6 (42)

R18: (SC 5, dec) x 6 (36)

Attach eyes, use embroidery thread for mouth and cheeks

R19-32: SC 36 (36)

Start stuffing

R33: (SC 4, dec) x 6 (30)

R34: (SC 3, dec) x 6 (24)

Stuff

R35: (SC 2, dec) x 6 (18)

R36: (SC, dec) x 6 (12)

Change color to brown

R37: BLO SC 12 (12)

R38-39: SC 12 (12)

Stuff

R40: BLO dec x 6 (6)

Tie off

You butternut squash me!

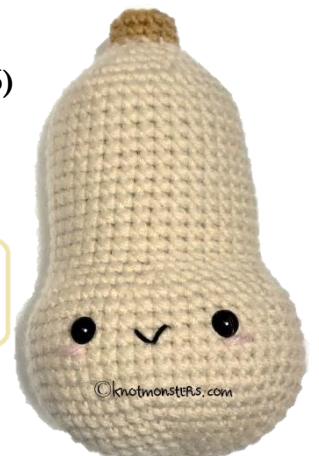



Zucchini

Difficulty: Easy

Hook: 4.0mm (G) or 3.75 mm (F)
hook

Approximate size: 16cm x 6cm

Eye: 6 mm

All rows completed in the round
unless otherwise indicated

BODY

Start with color dark green

R1: MR 6 (6)

R2: inc x 6 (12)

R3: (SC, inc) x 6 (18)

R4: (SC 2, inc) x 6 (24)

R5: (SC 3, inc) x 6 (30)

R6: (SC 4, inc) x 6 (36)

R7-14: SC 36 (36)

R15: (SC 4, dec) x 6 (30)

R16: SC 30 (30)

R17: dec, SC 28 (29)

R18: SC 29 (29)

R19: dec, SC 27 (28)

R20: SC 28 (28)

R21: dec, SC 26 (27)

R22: SC 27 (27)

R23: inc, SC 26 (28)

R24: SC 28 (28)

Attach eyes, use embroidery
thread for mouth and cheeks

R25: inc, SC 27 (29)

R26: SC 29 (29)

R27: inc, SC 28 (30)

R28: SC 30 (30)

R29: (SC 3, dec) x 6 (24)

R30-31: SC 24 (24)

Stuff

R32: (SC 2, dec) x 6 (18)

R33-34: SC 18 (18)

R35: (SC, dec) x 6 (12)

Change color to light green

R36: BLO SC 12 (12)

Stuff

R37: inc x 12 (24)

R38-39: SC 24 (24)

Tie off, fold light green portion
like an "X" and tie together



Itsy Bitsy
Teenie Weenie
Yellow Polka Dot
Zucchini



Basket

Difficulty: Easy

Hook: 4.0mm (G) or 3.75 mm (F) hook

Approximate size: 24cm x 10cm

All rows completed in the round unless otherwise indicated

BODY

Start with color grey (or any color preference)

“(3 HDC’s) = (3 half double crochets in 1 stitch)”

R1: ch 11, turn, starting in 2nd chain from hook, HDC 9, (3 HDC’s), continue onto other side of chain, HDC 9, (3 HDC’s) (24)

R2: [(3 HDC’s), HDC 9, (3 HDC’s), HDC] x 2 (32)

R3: [HDC 3, (3 HDC’s), HDC 10, (3 HDC’s), HDC] x 2 (40)

R4: [HDC 3, (3 HDC’s), HDC 12, (3 HDC’s), HDC 3] x 2 (48)

R5: [HDC 5, (3 HDC’s), HDC 14, (3 HDC’s), HDC 3] x 2 (56)

R6: [HDC 6, (3 HDC’s), HDC 16, (3 HDC’s), HDC 4] x 2 (64)

R7: [HDC 8, (3 HDC’s), HDC 18, (3 HDC’s), HDC 4] x 2 (72)

R8: [HDC 10, (3 HDC’s), HDC 20, (3 HDC’s), HDC 4] x 2 (80)

R9: [HDC 12, (3 HDC’s), HDC 22, (3 HDC’s), HDC 4] x 2 (88)

R10: [HDC 14, (3 HDC’s), HDC 24, (3 HDC’s), HDC 4] x 2 (96)

R11: [HDC 16, (3 HDC’s), HDC 26, (3 HDC’s), HDC 4] x 2 (104)

R12: [HDC 18, (3 HDC’s), HDC 28, (3 HDC’s), HDC 4] x 2 (112)

R13: [HDC 20, (3 HDC’s), HDC 30, (3 HDC’s), HDC 4] x 2 (120)

R14: [HDC 22, (3 HDC’s), HDC 32, (3 HDC’s), HDC 4] x 2 (128)

R15: [HDC 24, (3 HDC’s), HDC 34, (3 HDC’s), HDC 4] x 2 (136)

R16: [HDC 26, (3 HDC’s), HDC 36, (3 HDC’s), HDC 4] x 2 (144)

R17: BLO SC 144 (144)

R18-26: HDC 144 (144)

**R27: HDC 10, ch 20, skip 12
stitches, HDC 62, ch 20, skip 12
stitches, HDC 48 (144)**

**R28: SC 160 (160) – you will be
single crocheting up the chains
made from prior row**

R29: BLO SC 160 (160)

Tie off

Knot Monsters



Tote Bag

Difficulty: Easy

Hook: 5.5mm (I) hook

Approximate size: 60cm x 30cm

All rows completed in the round unless otherwise indicated

BODY

Start with color grey (or any color preference)

“DC inc = 2 DC’s in 1 st”

“TC inc = 2 TC’s in 1 st”

R1: 10 DC’s in a magic ring (10)

R2: DC inc x 10 (20)

R3: (DC, DC inc) x 10 (30)

R4: (DC 2, DC inc) x 10 (40)

R5: (DC 3, DC inc) x 10 (50)

R6: (DC 4, DC inc) x 10 (60)

R7: (DC 5, DC inc) x 10 (70)

R8: (DC 6, DC inc) x 10 (80)

R9: (DC 7, DC inc) x 10 (90)

R10: (TC 8, TC inc) x 10 (100)

R11-25: TC 100 (100) - *if a smaller bag is desired, crochet 10 instead of 15 rounds*

R26: SC 100 (100)

R27: HDC 100 (100)

R28-29: SC 100 (100)

R30: SC 25, ch 100, skip 25 stitches and SC 25, ch 100, skip 25 stitches (250)

R31: SC 250 (250) – crochet up and down chain

R32-33: SC 250 (250)

Tie off





Banana

Difficulty: Medium

Hook: 4.0mm (G) or 3.75 mm (F) hook

Approximate size: 16cm x 8cm

Eye: 6 mm

All rows completed in the round unless otherwise indicated

INNER BODY

Start with color tan

R1: MR 6 (6)

R2: inc x 6 (12)

R3: (SC, inc) x 6 (18)

R4: SC 18 (18)

R5: (SC 2, inc) x 6 (24)

R6: dec, SC 10, inc, SC 11 (24)

R7: SC 24 (24)

R8: dec, SC 10, inc, SC 11 (24)

R9: SC 24 (24)

R10: dec, SC 10, inc, SC 11 (24)

R11: SC 24 (24)

Attach eyes, use embroidery thread for mouth and cheeks

R12: dec, SC 10, inc, SC 11 (24)

R13-15: SC 24 (24)

R16: dec, SC 10, inc, SC 11 (24)

Begin stuffing

R17-22: SC 24 (24)

R23: inc, SC 10, dec, SC 11 (24)

R24-26: SC 24 (24)

R27: inc, SC 10, dec, SC 11 (24)

R28: SC 24 (24)

R29: inc, SC 10, dec, SC 11 (24)

R30: SC 24 (24)

R31: inc, SC 10, dec, SC 11 (24)

R32: SC 24 (24)

R33: inc, SC 10, dec, SC 11 (24)

R34: (SC 2, dec) x 6 (18)

Stuff

R35: (SC, dec) x 6 (12)

R36: dec x 6 (6)

Tie off

You are very
a-peel-ing 🍌



PEEL

Start with color brown

R1: MR 6 (6)

R2: BLO SC 6 (6)

R3: SC 6 (6)

Change color to yellow

R4: inc x 6 (12)

R5: (SC, inc) x 6 (18)

R6: (SC 2, inc) x 6 (24)

R7: SC 24 (24)

R8: (SC 3, inc) x 6 (30)

R9: dec, SC 13, inc, SC 14 (30)

R10: SC 30 (30)

R11: dec, SC 13, inc, SC 14 (30)

R12: SC 30 (30)

R13: dec, SC 13, inc, SC 14 (30)

R14: SC 30 (30)

R15: dec, SC 13, inc, SC 14 (30)

R16-18: SC 30 (30)

R19: dec, SC 13, inc, SC 14 (30)

R20-23: SC 30 (30)

Tie off

We will now be making the three peels, one at a time. The remainder of the pattern will be completed in the straight. At the end of each row, ch 1 and begin in 2nd chain from hook.

*R1-9: SC 10 (10)

R10: dec, SC 6, dec (8)

R11: dec, SC 4, dec (6)

R12: dec, SC 2, dec (4)

R13: dec, dec (2)

Tie off*

Count ten rows from the end of the last peel, and repeat from * to * to complete the two last peels.

Place body inside peel.





Apple

Difficulty: Easy

Hook: 4.0mm (G) or 3.75 mm (F) hook

Approximate size: 10cm x 10cm

Eye: 6 mm

All rows completed in the round unless otherwise indicated

BODY

Start with color red

R1: MR 6 (6)

R2: inc x 6 (12)

R3: (SC, inc) x 6 (18)

R4: (SC 2, inc) x 6 (24)

R5: (SC 3, inc) x 6 (30)

R6: SC 30 (30)

R7: (SC 4, inc) x 6 (36)

R8: SC 36 (36)

R9: (SC 5, inc) x 6 (42)

R10: SC 42 (42)

R11: (SC 6, inc) x 6 (48)

R12: SC 48 (48)

R13: (SC 7, inc) x 6 (54)

R14-18: SC 54 (54)

R19: (SC 7, dec) x 6 (48)

R20: (SC 6, dec) x 6 (42)

R21: (SC 5, dec) x 6 (36)

R22: (SC 4, dec) x 6 (30)

Attach eyes, use embroidery thread for mouth and cheeks

R23: (SC 3, dec) x 6 (24)

R24: (SC 2, dec) x 6 (18)

Stuff

R25: (SC, dec) x 6 (12)

R26: dec x 6 (6)

Tie off, leave end long

With end, sew from top to bottom and pull tight to create a small indentation on the top and bottom of the apple. Tie off.





An apple a day,
Keeps you crocheting away

LEAF

Start with color light green

Ch 8, turn and begin in 2nd chain from hook

R1: sl, SC, 4 HDC, SC, continue onto other side of chain, SC, 4 HDC, SC, sl (14)

Slip back into 1st stitch in R1

Tie off, leave end long for attaching to stem. Attach to stem.



STEM

Start with color brown

R1: MR 4 (4)

R2-5: SC 4 (4)

Tie off. Attach to stem.





PEAR

Difficulty: Easy

Hook: 4.0mm (G) or 3.75 mm (F) hook

Approximate size: 12cm x 9cm

Eye: 6 mm

All rows completed in the round unless otherwise indicated

BODY

Start with color light green

R1: MR 6 (6)

R2: inc x 6 (12)

R3: (SC, inc) x 6 (18)

R4: (SC 2, inc) x 6 (24)

R5: (SC 3, inc) x 6 (30)

R6: (SC 4, inc) x 6 (36)

R7: (SC 5, inc) x 6 (42)

R8: (SC 6, inc) x 6 (48)

R9-13: SC 48 (48)

R14: (SC 6, dec) x 6 (42)

R15: SC 42 (42)

R16: (SC 5, dec) x 6 (36)

R17: SC 36 (36)

Attach eyes, use embroidery thread for mouth and cheeks.

R18: (SC 4, dec) x 6 (30)

R19-23: SC 30 (30)

Stuff

R24: (SC 3, dec) x 6 (24)

R25: SC 24 (24)

R26: (SC 2, dec) x 6 (18)

Stuff

R27: (SC, dec) x 6 (12)

R28: dec x 6 (6)

Tie off, leave end long

With end, sew from top to bottom and pull tight to create a slight indentation on the top and bottom of the pear. Tie off.



We make a great pear



LEAF

Start with color dark green

Ch 8, turn and begin in 2nd chain from hook
from hook

R1: sl, SC, 4 HDC, SC, continue
onto other side of chain, SC, 4
HDC, SC, sl (14)

Slip back into 1st stitch in R1

Tie off, leave end long for
attaching to stem. Attach to
stem.



STEM

Start with color brown

R1: MR 4 (4)

R2-5: SC 4 (4)

Tie off. Attach to stem.





Orange

Difficulty: Easy

Hook: 4.0mm (G) or 3.75 mm (F)
hook

Approximate size: 10cm x 10cm

Eye: 6 mm

All rows completed in the round
unless otherwise indicated

BODY

Start with color orange

R1: MR 6 (6)

R2: inc x 6 (12)

R3: (SC, inc) x 6 (18)

R4: (SC 2, inc) x 6 (24)

R5: (SC 3, inc) x 6 (30)

R6: (SC 4, inc) x 6 (36)

R7: (SC 5, inc) x 6 (42)

R8: (SC 6, inc) x 6 (48)

R9: (SC 7, inc) x 6 (54)

R10-16: SC 54 (54)

R17: (SC 7, dec) x 6 (48)

R18: (SC 6, dec) x 6 (42)

Attach eyes, use embroidery
thread for mouth and cheeks

R19: (SC 5, dec) x 6 (36)

R20: (SC 4, dec) x 6 (30)

R21: (SC 3, dec) x 6 (24)

R22: (SC 2, dec) x 6 (18)

Stuff

R23: (SC, dec) x 6 (12)

R24: dec x 6 (6)

Tie off

You are my
main squeeze 🍊

LEAF

Start with color light green

Ch 8, turn and begin in 2nd chain from hook

R1: sl, SC, 4 HDC, SC, continue onto other side of chain, SC, 4 HDC, SC, sl (14)

Slip back into 1st stitch in R1

Tie off, leave end long for attaching to stem. Attach to stem.



STEM

Start with color brown

R1: MR 4 (4)

R2-5: SC 4 (4)

Tie off. Attach to stem.



Knot Monsters



Lemon

When life gives you lemons, I hope they are as cute as these!

Difficulty: Easy

Hook: 4.0mm (G) or 3.75 mm (F) hook

Approximate size: 10cm x 6cm

Eye: 4 mm

All rows completed in the round unless otherwise indicated

BODY

Start with color yellow

R1: MR 6 (6)

R2: SC 6 (6)

R3: inc x 6 (12)

R4: (SC, inc) x 6 (18)

R5: (SC 2, inc) x 6 (24)

R6: (SC 3, inc) x 6 (30)

R7: (SC 4, inc) x 6 (36)

R8-17: SC 36 (36)

R18: (SC 4, dec) x 6 (30)

Attach eyes, use embroidery thread for mouth and cheeks

R19: (SC 3, dec) x 6 (24)

R20: (SC 2, dec) x 6 (18)

Stuff

R21: (SC, dec) x 6 (12)

R22: dec x 6 (6)

Change color to green

R23: SC 6 (6)

Tie off



LEAF

Start with color light green

Ch 7, turn and begin in 2nd chain from hook

R1: sl, SC, HDC, DC, HDC, SC, continue onto other side of chain, SC, HDC, DC, HDC, SC, sl (12)

Slip back into 1st stitch in R1

Tie off, leave end long for attaching to stem. Attach to body.





Attach eyes, use embroidery thread for mouth and cheeks

R15: (SC 3, dec) x 6 (24)

R16: (SC 2, dec) x 6 (18)

Stuff

R17: (SC, dec) x 6 (12)

R18: dec x 6 (6)

R19: SC 6 (6)

Tie off

Lime

Difficulty: Easy

Hook: 4.0mm (G) or 3.75 mm (F)
hook

Approximate size: 8cm x 6cm

Eye: 4 mm

All rows completed in the round
unless otherwise indicated

BODY

Start with color light green

R1: MR 6 (6)

R2: SC 6 (6)

R3: inc x 6 (12)

R4: (SC, inc) x 6 (18)

R5: (SC 2, inc) x 6 (24)

R6: (SC 3, inc) x 6 (30)

R7-14: SC 30 (30)

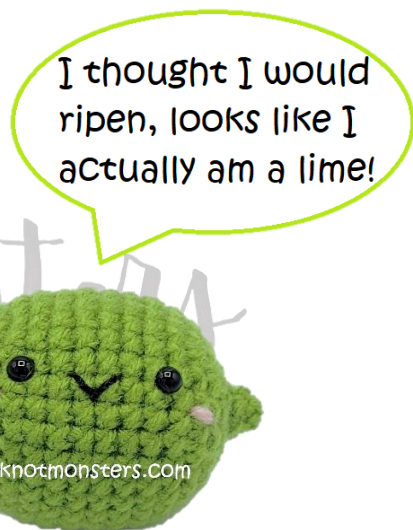



Attach eyes, use embroidery thread for mouth and cheeks

R13: (SC 4, dec) x 6 (30)

R14: (SC 3, dec) x 6 (24)

R15: (SC 2, dec) x 6 (18)

Stuff

R16: BLO (SC, dec) x 6 (12)

R17: dec x6 (6)

Tie off

The next part will be attached to the front loops made by R16.

Begin by attaching new yarn and SC 18, then slip stitch into the first stitch. For the next round:
FLO (2 HDC in 1 st, 2 DC in 1 st, 2 HDC in 1 st) x 6



BLUEBERRY

Difficulty: Medium

Hook: 4.0mm (G) or 3.75 mm (F) hook

Approximate size: 8cm x 6cm

Eye: 4 mm

All rows completed in the round unless otherwise indicated

BODY

Start with color blue

R1: MR 6 (6)

R2: inc x 6 (12)

R3: (SC, inc) x 6 (18)

R4: (SC 2, inc) x 6 (24)

R5: (SC 3, inc) x 6 (30)

R6: (SC 4, inc) x 6 (36)

R7: (SC 5, inc) x 6 (42)

R8-11: SC 42 (42)

R12: (SC 5, dec) x 6 (36)



Feeling down?
This not so blue, blueberry
will cheer you up



RaspBERRY

Difficulty: Advanced

Hook: 4.0mm (G) or 3.75 mm (F) hook

Approximate size: 12cm x 10cm

Eye: 6 mm

All rows completed in the round unless otherwise indicated

BODY

Start with color magenta

R1: MR 6 (6)

R2: inc x 6 (12)

R3: (puff, SC) x 6 (12)

R4: (puff, inc) x 6 (18)

R5: (puff, SC) x 9 (18)

R6: (puff, SC, inc) x 6 (24)

R7: (puff, SC) x 12 (24)

R8: (puff, SC, puff, inc) x 6 (30)

R9: (puff, SC) x 15 (30)

R10: (puff, SC, puff, SC, inc) x 6 (36)

R11: (puff, SC) x 18 (36)

R12: BLO (SC 4, dec) x 6 (30)

Attach eyes. Use embroidery thread for mouth and cheeks.

R13: BLO SC 30 (30)

R14: (SC 3, dec) x 6 (24)

R15: SC 24 (24)

R16: (SC 2, dec) x 6 (18)

R17: SC 18 (18)

Place a thin layer of stuffing evenly throughout body (we will be inverting the top so we are leaving room for the inversion)

R18: (SC, dec) x 6 (12)

R19: SC 12 (12)

R20: (dec) x 6 (6)

Tie off, invert top portion

Did you know there are over 200 varieties of raspberries? They range in color from red to purple to yellow!



STEM

Part 1

Start with color light green

R1: MR 4 (4)

R2-5: SC 4 (4)

R6: (SC, inc) x 2 (6)

R7: FLO inc x 6 (12)

R8: (SC, inc) x 6 (18)

R9: (SC 2, inc) x 6 (24)

R10: (SC 3, inc) x 6 (30)

R11: (sl, ch 6, turn and starting in 2nd chain from hook: sl, SC, HDC, DC, TC – down chain. Skip 3 stitches, sl) x 6 (30)

Tie off, leave end long for attaching to part 2.

Part 2

Start with color tan

R1: MR 6 (6)

R2: inc x 6 (12)

R3: SC 12 (12)

R4: (SC, inc) x 6 (18)

R5: SC 18 (18)

R6: (SC 2, inc) x 6 (24)

R7: BLO (SC 2, dec) x 6 (18)

Stuff

R8: (SC, dec) x 6 (12)

R9: dec x 6 (6)

Tie off, attach to part 1





CHERRY

Difficulty: Easy

Hook: 4.0mm (G) or 3.75 mm (F) hook

Approximate size: 6cm x 10cm

Eye: 4 mm

All rows completed in the round unless otherwise indicated

BODY (make 2)

Start with color red

R1: MR 6 (6)

R2: inc x 6 (12)

R3: (SC, inc) x 6 (18)

R4: (SC 2, inc) x 6 (24)

R5-7: SC 24 (24)

R8: (SC 2, dec) x 6 (18)

Attach eyes, use embroidery thread for mouth and cheeks

Stuff

R9: (SC, dec) x 6 (12)

R10: dec x 6 (6)

Tie off



LEAF (make 2)

Start with color light green

Ch 17, turn and begin in 2nd chain from hook

R1: (sl, SC, HDC, 2 DC, HDC, SC, sl) x 2, continue onto other side of chain, (sl, SC, HDC, 2 DC, HDC, SC, sl) x 2 (32)

Slip back into 1st stitch in R1

Tie off, leave end long for attaching to stem. Attach to stem.



STEM (make 2)

Start with color light green

Ch 12

Tie off. Attach to leaf and body.



Merci mon cherry



Strawberry

Difficulty: Medium

Hook: 4.0mm (G) or 3.75 mm (F)
hook

Approximate size: 12cm x 10cm

Eye: 6 mm

All rows completed in the round
unless otherwise indicated

BODY

Start with color red

R1: MR 6 (6)

R2: inc x 6 (12)

R3: SC 12 (12)

R4: (SC, inc) x 6 (18)

R5: SC 18 (18)

R6: (SC 2, inc) x 6 (24)

R7: SC 24 (24)

R8: (SC 3, inc) x 6 (30)

R9: SC 30 (30)

R10: (SC 4, inc) x 6 (36)

R11: SC 36 (36)

R12: (SC 5, inc) x 6 (42)

R13: SC 42 (42)

R14: (SC 6, inc) x 6 (48)

R15: SC 48 (48)

R16: (SC 6, dec) x 6 (42)

R17: (SC 5, dec) x 6 (36)

R18: (SC 4, dec) x 6 (30)

Attach eyes, use embroidery
thread for mouth and cheeks

R19: (SC 3, dec) x 6 (24)

R20: (SC 2, dec) x 6 (18)

Stuff

R21: (SC, dec) x 6 (12)

R22: dec x 6 (6)

Tie off, use white yarn to make
seeds.



What do you call a
sad strawberry?
A blue berry!

STEM

Start with color light green

R1: MR 4 (4)

R2-5: SC 4 (4)

R6: (SC, inc) x 2 (6)

R7: FLO inc x 6 (12)

R8: (SC, inc) x 6 (18)

R9: (SC 2, inc) x 6 (24)

R10: (SC 3, inc) x 6 (30)

R11: (sl, ch 6, turn and starting in 2nd chain from hook: sl, SC, HDC, DC, TC – down chain. Skip 3 stitches, sl) x 6 (30)

Tie off, leave end long and attach to body





STEM

Start with color brown

R1: MR 5 (5)

R2-21: SC 5 (5)

Tie off. We will be attaching grapes, one row at a time. The rows will contain the following # of grapes: 1, 3, 5, 5, 3. See pictures.



Grapes

Difficulty: Medium

Hook: 4.0mm (G) or 3.75 mm (F) hook

Approximate size: 18cm x 8cm

All rows completed in the round unless otherwise indicated



BODY (make 17)

Start with color purple

R1: MR 6 (6)

R2: inc x 6 (12)

R3-5: SC 12 (12)

Stuff

R6: dec x 6 (6)

Tie off





LEAF

Start with color green

Crocheted in the straight

R1: Ch 6, turn, starting in 2nd chain from hook, SC 4, 3 SC's in 1 st, continue onto other side of chain, SC 5 (12)

-At the end of each row, ch 1, turn and begin next row in 2nd chain from hook

R2: SC 5, inc, inc, SC 4 (13)

R3: SC 5, inc, inc, SC 5 (12)

R4: SC 5, inc, inc, inc, SC 5 (16)

R5: SC 7, inc, inc, SC 6 (17)

R6: SC 7, inc, inc, SC 7 (18)

Tie off and attach to stem



Why are grapes
never lonely?
Because they are
always in bunches!



Plum

Difficulty: Easy

Hook: 4.0mm (G) or 3.75 mm (F) hook

Approximate size: 8cm x 8cm

Eye: 4 mm

All rows completed in the round unless otherwise indicated

BODY

Start with color purple

R1: MR 6 (6)

R2: inc x 6 (12)

R3: (SC, inc) x 6 (18)

R4: (SC 2, inc) x 6 (24)

R5: (SC 3, inc) x 6 (30)

R6: (SC 4, inc) x 6 (36)

R7: (SC 5, inc) x 6 (42)

R8-14: SC 42 (42)

R15: (SC 5, dec) x 6 (36)

Attach eyes, use embroidery thread for mouth and cheeks

R16: (SC 4, dec) x 6 (30)

R17: (SC 3, dec) x 6 (24)

R18: (SC 2, dec) x 6 (18)

Stuff

R19: (SC, dec) x 6 (12)

R20: dec x 6 (6)

Tie off

Leave end long

Using the long end, thread yarn needle through top of body and out through bottom of body.

Pull tightly to compress top and bottom of body.



Knot Monsters

What fruit will fix your sink?
A Plum-er!



LEAF

Start with color light green

Ch 8, turn and begin in 2nd chain from hook

R1: sl, SC, 4 HDC, SC, continue onto other side of chain, SC, 4 HDC, SC, sl (14)

Slip back into 1st stitch in R1

Tie off, leave end long for attaching to stem. Attach to body.

STEM

Start with color brown

R1: MR 4 (4)

R2-4: SC 4 (4)

Tie off. Attach to body.



Knot Monsters



Tomato

Difficulty: Easy

Hook: 4.0mm (G) or 3.75 mm (F) hook

Approximate size: 10cm x 8cm

Eye: 6 mm

All rows completed in the round unless otherwise indicated

BODY

Start with color red

R1: MR 6 (6)

R2: inc x 6 (12)

R3: (SC, inc) x 6 (18)

R4: (SC 2, inc) x 6 (24)

R5: (SC 3, inc) x 6 (30)

R6: (SC 4, inc) x 6 (36)

R7: (SC 5, inc) x 6 (42)

R8: (SC 6, inc) x 6 (48)

R9: (SC 7, inc) x 6 (54)

R10-14: SC 54 (54)

R15: (SC 7, dec) x 6 (48)

R16: (SC 6, dec) x 6 (42)

Attach eyes, use embroidery thread for mouth and cheeks

R17: (SC 5, dec) x 6 (36)

R18: (SC 4, dec) x 6 (30)

R19: (SC 3, dec) x 6 (24)

R20: (SC 2, dec) x 6 (18)

Stuff

R21: (SC, dec) x 6 (12)

R22: dec x 6 (6)

Tie off



STEM

Start with color light green

R1: MR 5 (5)

R2-4: SC 5 (5)

R5: FLO inc x 5 (10)

R6: (SC, inc) x 5 (15)

R7: (sl, ch 6, turn, starting in 2nd chain from hook: sl 2, SC 3 (down chain), skip 1 st, sl) x 5

Tie off, leave end long for attaching to stem. Attach to stem.



I love you from my head down tomatoes!





Tomato with Strawberry Pin Cushion EMERY

Difficulty: Medium

Hook: 4.0mm (G) or 3.75 mm (F)
hook

Approximate size: 10cm x 6cm

Eye: 4 mm

All rows completed in the round
unless otherwise indicated

TOMATO BODY

Start with color red

R1: MR 6 (6)

R2: inc x 6 (12)

R3: (SC, inc) x 6 (18)

R4: (SC 2, inc) x 6 (24)

R5: (SC 3, inc) x 6 (30)

R6: (SC 4, inc) x 6 (36)

R7: (SC 5, inc) x 6 (42)

R8: (SC 6, inc) x 6 (48)

R9-12: SC 48 (48)

R13: (SC 6, dec) x 6 (42)

Attach eyes, use embroidery
thread for mouth and cheeks

R14: (SC 5, dec) x 6 (36)

R15: (SC 4, dec) x 6 (30)

R16: (SC 3, dec) x 6 (24)

R17: (SC 2, dec) x 6 (18)

Stuff

R18: (SC, dec) x 6 (12)

R19: dec x 6 (6)

Tie off



TOMATO STEM

Start with color green

R1: MR 6 (6)

R2: inc x 6 (12)

R3: sl, (ch 4, turn, starting in 2nd
chain from hook: sl, SC, HDC
(down chain), skip 1 st, sl) x 6 –
last sl will be into first sl

Tie off, leave end long for
attaching to body. Attach to
body.



Using a long piece of green yarn, thread yarn through bottom of body and out through top of body. Bring needle back up and thread through entire body again. Repeat this a total of 6 times. Leave end long at top of body and thread this through the middle of the stem. Attach this portion to strawberry. Use long end of stem to attach stem to body.



STRAWBERRY

Start with color red

R1: MR 6 (6)

R2: SC 6 (6)

R3: inc x 6 (12)

R4-5: SC 12 (12)

Change to color green

R6: FLO inc x 12 (24)

R7: dec x 12 (12)

Stuff

R8: dec x 6 (6)

Tie off, attach to main body



Avocado

Difficulty: Medium

Hook: 4.0mm (G) or 3.75 mm (F)
hook

Approximate size: 10cm x 8cm

Eye: 4 mm

All rows completed in the round
unless otherwise indicated

BODY (part 1)

Start with color light brown

R1: MR 6 (6)

R2: inc x 6 (12)

R3: (SC, inc) x 6 (18)

R4: (SC 2, inc) x 6 (24)

R5-6: SC 24 (24)

Change color to light green

R7: (SC 3, inc) x 6 (30)

R8: (SC 4, inc) x 6 (36)

R9: (SC 5, inc) x 5, SC 5, ch 1,
turn (41)

*The rest of the body will be
crocheted in the straight*

-At the end of each row, ch 1,
turn and begin in 2nd chain from
stitch

R10: dec, SC 10, dec (12)

R11: dec, SC 8, dec (10)

R12: dec, SC 6, dec (8)

R13: dec, SC 4, dec (6)

R14: dec, SC 2, dec (4)

R15: dec, dec (2)

Tie off, leave end long for
sewing

Attach eyes, use embroidery
thread for mouth and cheeks



BODY (part 2)

Start with color dark green

Crocheted in the straight

At the end of each row, ch 1, turn and begin in 2nd chain from stitch

R1: MR 3 (3)

R2: inc x 3 (6)

R3: (SC, inc) x 3 (9)

R4: (SC 2, inc) x 3 (12)

R5: (SC 3, inc) x 3 (15)

R6: (SC 4, inc) x 3 (18)

R7: (SC 5, inc) x 3 (21)

R8-14: SC 21 (21)

R15: (SC 5, dec) x 3 (18)

R16: SC 18 (18)

R17: (SC 4, dec) x 3 (15)

R18: SC 15 (15)

R19: (SC 3, dec) x 3 (12)

R20: SC 12 (12)

R21: (SC 2, dec) x 3 (9)

R22: SC 9 (9)

R23: (SC, dec) x 3 (6)

R24: SC 6 (6)

R25: dec x 3 (3)

Place body part 1 on top of body part 2 and single crochet along the edges to attach the two pieces. Stuff before finishing.



Great Job!
Bravocado!



Mini Watermelon

Difficulty: Advanced (lots of color work)

Hook: 4.0mm (G) or 3.75 mm (F) hook

Approximate size: 12cm x 8cm

Eye: 6 mm

All rows completed in the round unless otherwise indicated

BODY

Stitch will be highlighted in the color that you will be using for that stitch.

Colors: Light Green, Dark Green.

R1: MR 6 (6)

R2: inc x 6 (12)

R3: (SC, inc) x 6 (18)

R4: (SC 2, inc) x 6 (24)

R5: (SC 3, inc) x 6 (30)

R6: (SC 4, inc) x 6 (36)

R7: (SC 5, inc) x 6 (42)

R8: (SC 6, inc) x 6 (48)

R9-18: (SC 6, SC 2) x 6 (48)

R19: (SC 5, SC, dec) x 6 (42)

Attach eyes, use embroidery thread for mouth and cheeks

R20: (SC 4, SC, dec) x 6 (36)

R21: (SC 3, SC, dec) x 6 (30)

R22: (SC 2, SC, dec) x 6 (24)

R23: (SC, SC, dec) x 6 (18)

Stuff

Switch color to light brown

R24: (SC, dec) x 6 (12)

R25: dec x 6 (6)

R26: SC 6 (6)

R27: dec, SC 4 (5)

R28: SC 5 (5)

Tie off



You are one
in a melon





Watermelon Slice & Wedge

Difficulty: Medium

Hook: 4.0mm (G) or 3.75 mm (F)
hook

Approximate size: 10cm x 8cm
(wedge), 18cm x 6cm (slice)

Eye: 6 mm

All rows completed in the round
unless otherwise indicated

VERSION 1

BODY

Start with color dark green

R1: Ch 16, turn, starting in 2nd
chain from hook SC 14, 3 SC's in
1 stitch, continue onto other side
of chain, SC 14, 3 SC's in 1 stitch
(34)

R2: inc, SC 14, inc x 3, SC 14, inc
x 2 (40)

R3: inc, SC 16, inc x 4, SC 16, inc
x 3 (48)

R4: BLO SC 48 (48)

R5-6: SC 48 (48)

Switch to color light green

R7: (SC 6, dec) x 6 (42)

Switch to color white

R8: SC 42 (42)

Change color to pink

R9-10: SC 42 (42)

R11: (SC 5, dec) x 6 (36)

R12-14: SC 36 (36)

Attach eyes, use embroidery
thread for mouth and cheeks

R15: (SC 4, dec) x 6 (30)

R16-18: SC 30 (30)

R19: (SC 3, dec) x 6 (24)

R20-22: SC 24 (24)

R23: (SC 2, dec) x 6 (18)

Stuff

R24-26: SC 18 (18)

R27: (SC, dec) x 6 (12)

Finish stuffing

R28: dec x 6 (6)

Tie off

Using black yarn, sew seeds
onto body



VERSION 2

BODY (part 1)

Start with color pink

R1: MR 6 (6)

R2: inc x 6 (12)

R3: (SC, inc) x 6 (18)

R4: (SC 2, inc) x 6 (24)

R5: (SC 3, inc) x 6 (30)

R6: (SC 4, inc) x 6 (36)

R7: (SC 5, inc) x 6 (42)

R8: (SC 6, inc) x 6 (48)

R9: (SC 7, inc) x 6 (54)

R10: (SC 8, inc) x 6 (60)

R11: (SC 9, inc) x 6 (66)

R12: (SC 10, inc) x 6 (72)

Switch to color white

R13: (SC 11, inc) x 6 (78)

Switch to color light green

R13: (SC 12, inc) x 6 (84)

Switch to color dark green

R14: (SC 13, inc) x 6 (90)

R15: (SC 14, inc) x 6 (96)

Attach eyes, use embroidery thread for mouth and cheeks

Tie off



BODY (part 2)

Start with color dark green

Crocheted in the straight

At the end of each row, ch 1, turn and start the next row in 2nd chain from hook
chain from hook

Ch 2

R1-2: SC 1 (1)

R3: inc (2)

R4-5: SC 2 (2)

R6: inc x 2 (4)

R7-8: SC 4 (4)

R9: inc, SC 2, inc (6)

R10-12: SC 6 (6)

R13: inc, SC 4, inc (8)

R14-17: SC 8 (8)

R18: inc, SC 6, inc (10)

R19-30: SC 10 (10)

R31: dec, SC 6, dec (8)

R32-35: SC 8 (8)

R36: dec, SC 4, dec (6)

R37-39: SC 6 (6)

R40: dec, SC 2, dec (4)

R41-42: SC 4 (4)

R43: dec x 2 (2)

R44-45: SC 2 (2)

R46: dec (1)

R47-48: SC 1 (1)

Tie off, leave end very long for sewing. Fold body part 1 in half and attach to body part 1. Stuff before closing completely.



When do you go at red but stop at green?
When eating a watermelon!



Kiwi

Difficulty: Easy

Hook: 4.0mm (G) or 3.75 mm (F)
hook

Approximate size: 8cm x 8cm

Eye: 4 mm

All rows completed in the round
unless otherwise indicated

BODY

Start with color white

R1: MR 6 (6)

R2: inc x 6 (12)

Change color to black

R3: BLO (SC, inc) x 6 (18)

Change color to green

R4: (SC 2, inc) x 6 (24)

R5: (SC 3, inc) x 6 (30)

R6: (SC 4, inc) x 6 (36)

Attach eyes, use embroidery
thread for mouth and cheeks

Change color to brown

R7: BLO SC 36 (36)

R8-12: SC 36 (36)

R13: (SC 4, dec) x 6 (30)

R14: (SC 3, dec) x 6 (24)

R15: (SC 2, dec) x 6 (18)

Stuff

R16: (SC, dec) x 6 (12)

R17: dec x 6 (6)

Tie off





Mango

Difficulty: Medium

Hook: 4.0mm (G) or 3.75 mm (F) hook

Approximate size: 14cm x 8cm

Eye: 6 mm

All rows completed in the round unless otherwise indicated

BODY

Start with color yellow

R1: Ch 7, turn, starting in 2nd chain from hook, SC 6, continue onto other side of chain, SC 6 (12)

R2: (inc, SC 4, inc) x 2 (16)

R3: (inc x 2, SC 5, inc) x 2 (22)

R4: (inc x 3, SC 7, inc) x 2 (30)

R5: (inc x 3, SC 12) x 2 (36)

R6-15: SC 36 (36)

Attach eyes, use embroidery thread for mouth and cheeks

R16: SC 20, dec x 2, SC 12 (34)

R17-19: SC 34 (34)

R20: SC 20, dec x 2, SC 10 (32)

R21-23: SC 32 (32)

R24: SC 19, dec x 2, SC 9 (30)

Begin stuffing

R25: (SC 3, dec) x 6 (24)

R26: (SC 2, dec) x 6 (18)

Stuff

R27: (SC, dec) x 6 (12)

R28: dec x 6 (6)

Tie off



STEM

Start with color brown

R1: MR 4 (4)

R2-3: SC 4 (4)

Tie off, attach to body

It takes two,
to mango

LEAF

Start with yarn color dark green

Ch 9, turn and begin in 2nd chain from hook

R1: sl, SC, HDC, DC 3, HDC, SC, continue onto other side of chain, SC, HDC, DC 3, HDC, SC, sl (16)

Slip back into 1st stitch in R1

Tie off, leave end long for attaching to stem. Attach to stem.





Peach

Difficulty: Easy

Hook: 4.0mm (G) or 3.75 mm (F)
hook

Approximate size: 8cm x 8cm

Eye: 4 mm

All rows completed in the round
unless otherwise indicated

BODY

Start with color peach

R1: MR 6 (6)

R2: inc x 6 (12)

R3: (SC, inc) x 6 (18)

R4: (SC 2, inc) x 6 (24)

R5: (SC 3, inc) x 6 (30)

R6: (SC 4, inc) x 6 (36)

R7: (SC 5, inc) x 6 (42)

R8: (SC 6, inc) x 6 (48)

R9-14: SC 48 (48)

R15: (SC 6, dec) x 6 (42)

R16: (SC 5, dec) x 6 (36)

Attach eyes, use embroidery
thread for mouth and cheeks

R17: (SC 4, dec) x 6 (30)

R18: (SC 3, dec) x 6 (24)

R19: (SC 2, dec) x 6 (18)

Stuff

R20: (SC, dec) x 6 (12)

R21: dec x 6 (6)

R22: SC 6 (6)

R23: (SC, dec) x 2 (4)

Tie off

Leave end long

Using the long end, thread yarn
needle through top and bottom
of body as shown in photos. Pull
to compress top and bottom of
body slightly.



LEAF

Start with color light green

Ch 8, turn and begin in 2nd chain from hook

R1: sl, SC, 4 HDC, SC, continue onto other side of chain, SC, 4 HDC, SC, sl (14)

Slip back into 1st stitch in R1

Tie off, leave end long for attaching to stem. Attach to body.



Monsters

STEM

Start with color brown

R1: MR 4 (4)

R2-4: SC 4 (4)

Tie off. Attach to body.

You are such a peach!





Grapefruit

Difficulty: Easy

Hook: 4.0mm (G) or 3.75 mm (F) hook

Approximate size: 10cm x 6cm

Eye: 4 mm

All rows completed in the round unless otherwise indicated

BODY

Start with color white

R1: MR 6 (6)

Switch color to pink

R2: inc x 6 (12)

R3: (SC, inc) x 6 (18)

R4: (SC 2, inc) x 6 (24)

R5: (SC 3, inc) x 6 (30)

R6: (SC 4, inc) x 6 (36)

R7: (SC 5, inc) x 6 (42)

R8: (SC 6, inc) x 6 (48)

R9: (SC 7, inc) x 6 (54)

Switch to color white

R10: (SC 8, inc) x 6 (60)

Using white yarn, thread several white lines from center of piece to outer white line

Attach eyes, use embroidery thread for mouth and cheeks

Switch color to yellow

R11: BLO SC 60 (60)

R12-17: SC 60 (60)

R18: (SC 8, dec) x 6 (54)

R19: (SC 7, dec) x 6 (48)

R20: (SC 6, dec) x 6 (42)

R21: (SC 5, dec) x 6 (36)

Stuff

R22: (SC 4, dec) x 6 (30)

R23: (SC 3, dec) x 6 (24)

R24: (SC 2, dec) x 6 (18)

Stuff

R25: (SC, dec) x 6 (12)

R26: dec x 6 (6)

Tie off

A grapefruit is a great fruit





Pineapple

Difficulty: Advanced (prior knowledge of bobble stitch recommended)

Hook: 4.0mm (G) or 3.75 mm (F) hook

Approximate size: 20cm x 10cm

Eye: 6 mm

All rows completed in the round unless otherwise indicated

BODY

Start with color yellow

R1: MR 6 (6)

R2: inc x 6 (12)

R3: (SC, inc) x 6 (18)

R4: (SC 2, inc) x 6 (24)

R5: (SC 3, inc) x 6 (30)

R6: BLO (bobble, SC) x 15 (30)

R7: (SC, bobble, SC, bobble, inc) x 6 (36)

R8-17: (bobble, SC) x 18 (36)

Attach eyes, use embroidery thread for mouth and cheeks

R18: (bobble, SC, bobble, SC, dec) x 6 (30)

R19: (bobble, SC, bobble, dec) x 6 (24)

Stuff

R20: (bobble, SC, dec) x 6 (18)

R21: (bobble, dec) x 6 (12)

R22: dec x 6 (6)

Tie off



This pineapple is
one fine-apple

LEAF (make 6)

Start with color light green

R1: MR 6 (6)

R2-3: SC 6 (6)

R4: inc x 6 (12)

R5-7: SC 12 (12)

R8: (SC, inc) x 6 (18)

R9-18: SC 18 (18)

Tie off, do not stuff. Leave end long for attaching to body.

Attach to body by attaching four around row 20 and two around row 21.



Knot Monsters



Bobble Stitch

A bobble stitch is essentially 5 unfinished double crochets all linked together

Begin by making a double crochet but do not finish the last step (Fig 1-3)

Continue until a total of 5 incomplete double crochets are on your hook

Pull yarn through all of them (Fig 7)

Typically the pattern will have you single crochet into the next stitch to complete the bobble (Fig 8)

You can press the bobble out with your finger when completed



Pomegranate

Difficulty: Easy

Hook: 4.0mm (G) or 3.75 mm (F)
hook

Approximate size: 8cm x 8cm

Eye: 6 mm

All rows completed in the round
unless otherwise indicated

BODY

Start with color deep red

R1: MR 6 (6)

R2: inc x 6 (12)

R3: (SC, inc) x 6 (18)

R4: (SC 2, inc) x 6 (24)

R5: (SC 3, inc) x 6 (30)

R6: (SC 4, inc) x 6 (36)

R7: (SC 5, inc) x 6 (42)

R8: (SC 6, inc) x 6 (48)

R9-13: SC 48 (48)

R14: (SC 6, dec) x 6 (42)

R15: (SC 5, dec) x 6 (36)

Attach eyes, use embroidery
thread for mouth and cheeks

R16: (SC 4, dec) x 6 (30)

R17: (SC 3, dec) x 6 (24)

R18: (SC 2, dec) x 6 (18)

Stuff

R19: (SC, dec) x 6 (12)

R20: dec x 6 (6)

R21: SC 6 (6)

R22: (sl, ch 3, turn, starting in 2nd
chain from hook: SC 2 – down
chain) x 5, sl into first stitch in
row and tie off



Did you know that the
pomegranate is also known
as the fruit of love?



Mixed Nuts

Difficulty: Easy

Hook: 4.0mm (G) or 3.75 mm (F)
hook

Approximate size: ~7mm

Eye: 4 mm

All rows completed in the round
unless otherwise indicated

ACORN

Start with color tan

R1: MR 4 (4)

R2: SC 4 (4)

R3: (SC, inc) x 2 (6)

R4: inc x 6 (12)

R5: (SC, inc) x 6 (18)

R6: (SC 2, inc) x 6 (24)

R7-11: SC 24 (24)

Change color to brown

R12: FLO inc x 24 (48)

R13: BLO (SC 6, dec) x 6 (42)

Attach eyes, use embroidery
thread for mouth and cheeks

R14: (SC 5, dec) x 6 (36)

R15: (SC 4, dec) x 6 (30)

R16: (SC 3, dec) x 6 (24)

R17: (SC 2, dec) x 6 (18)

Stuff

R18: (SC, dec) x 6 (12)

R19: dec x 6 (6)

R20: SC 6 (6)

Tie off

PEANUT

Start with color light brown

R1: MR 6 (6)

R2: inc x 6 (12)

R3: (SC, inc) x 6 (18)

R4-9: SC 18 (18)

R10: (SC, dec) x 6 (12)

Stuff

R11: (SC, inc) x 6 (18)

R12-16: SC 18 (18)

Attach eyes, use embroidery
thread for mouth and cheeks

R17: (SC, dec) x 6 (12)

Stuff

R18: dec x 6 (6)

Tie off

CASHEW

Start with color cream

R1: MR 6 (6)

R2: inc x 6 (12)

R3: (SC, inc) x 6 (18)

R4-8: dec, SC 7, inc, SC 8 (18)

R9-11: SC 18 (18)

R12-16: inc, SC 7, dec, SC 8 (18)

Attach eyes, use embroidery
thread for mouth and cheeks

Stuff

R17: (SC, dec) x 6 (12)

R18: dec x 6 (6)

Tie off

Knot Monsters



PERSIMMON

Difficulty: Medium

Hook: 4.0mm (G) or 3.75 mm (F)
hook

Approximate size: 10cm x 8cm

Eye: 6 mm

All rows completed in the round
unless otherwise indicated

BODY

Start with color dark orange

R1: MR 6 (6)

R2: inc x 6 (12)

R3: (SC, inc) x 6 (18)

R4: (SC 2, inc) x 6 (24)

R5: (SC 3, inc) x 6 (30)

R6: (SC 4, inc) x 6 (36)

R7: (SC 5, inc) x 6 (42)

R8: (SC 6, inc) x 6 (48)

R9: (SC 7, inc) x 6 (54)

R10-14: SC 54 (54)

R15: (SC 7, dec) x 6 (48)

R16: (SC 6, dec) x 6 (42)

Attach eyes, use embroidery
thread for mouth and cheeks

R17: (SC 5, dec) x 6 (36)

R18: (SC 4, dec) x 6 (30)

R19: (SC 3, dec) x 6 (24)

R20: (SC 2, dec) x 6 (18)

Stuff

R21: (SC, dec) x 6 (12)

R22: dec x 6 (6)

Tie off



It can take a persimmon
tree 7 years to bear fruit

LEAF

Start with color grey or brown

R1: MR 6 (6)

R2: inc x 6 (12)

R3: (SC, inc) x 6 (18)

R4: (SC 2, inc) x 6 (24)

R5: (inc, 2 DC's in 1 st, 2 TC's in 1 st, ch 2, turn, in 2nd chain from hook: HDC down chain, 2 TC's in 1 st, 2 DC's in 1 st, inc) x 4

Tie off, leave end long for attaching to body. Attach to body.





About the Author

Michael grew up in sunny Las Vegas, Nevada and currently works as a pediatric dentist. His favorite thing in the world is to make others smile, and he hopes his little stuffed creations will bring many more smiles all over the world.

Some fun facts about Michael: His favorite animal is a penguin. Favorite children's movie is "Elf." Favorite sport is roller skating. Favorite crochet pattern is his sunflower pattern. His fondest crochet memory is first starting crocheting and taking three days and many tears to make a crochet ball. A skill that most people do not know about is that he once stacked fifteen Cheerios. If he were a superhero, his superpower would be super speed. He can also recite the general prologue of *The Canterbury Tales* in old English, which has thus far proved completely useless ☺.