



MYLES THE RAY

Myles works as a postman, delivering letters and packages to aquatic creatures living all over the ocean floor. He's quite smart and resourceful: as lots of ocean-dwellers don't really have a fixed address, he needs to figure out their whereabouts as he goes along. He takes great pride in his job (even if some mail is a bit soggy upon arrival), and loves seeing the happy faces of everyone who finds something nice in their mailbox.

MATERIALS

Sport weight yarn in: • off-white • dark blue • spring green / Scraps of yarn in different colors for embroidery, including pink, spring green and dark blue (you may want to use embroidery thread) / B-1 / 2 mm crochet hook / Black safety eyes (6 mm) / Sewing needle / Yarn needle / Pins / Stitch markers / Fiberfill for stuffing / Optional: pipe cleaner or wire for the tail (approx. 7" / 18 cm)

SKILL LEVEL



SIZE

10" / 26 cm tall when made with the indicated yarn.



Scan or visit www.amigurumi.com/5102 to share pictures and find inspiration.

HEAD AND BODY (start in dark blue yarn)

Note: Myles' head and body are crocheted in two colors. Depending on your personal crochet tension, the color change line might twist slightly. To address this, you can: (1) try x-single crochet instead of v-single crochet if you're comfortable with this technique, (2) straighten the body after stuffing, (3) use the color change line as the base line for sewing the fins on or (4) add some strategic embroidery (I think Myles would look great with some tattoos).

Crochet the head and body by alternating dark blue and off-white yarn. The color change is indicated in italics.

Rnd 1: start (*dark blue*) 3 sc + (*off-white*) 3 sc in a magic ring [6] ①

Rnd 2: (*dark blue*) inc in next st, sc in next st, inc in next st, (*off-white*) inc in next st, sc in next st, inc in next st [10]

Rnd 3: (*dark blue*) inc in next 2 st, sc in next st, inc in next 2 st, (*off-white*) inc in next 2 st, sc in next st, inc in next 2 st [18]

Rnd 4: (*dark blue*) inc in next st, sc in next st, inc in next st, sc in next 3 st, inc in next st, sc in next st, inc in next st, (*off-white*) inc in next st, sc in next st, inc in next st, sc in next 3 st, inc in next st, sc in next st, inc in next st [26]

Rnd 5 – 6: (*dark blue*) sc in next 13 st, (*off-white*) sc in next 13 st [26]

Rnd 7: (*dark blue*) inc in next st, sc in next st, inc in next st, sc in next 7 st, inc in next st, sc in next st, inc in next st, (*off-white*) inc in next st, sc in next st, inc in next st, sc in next 7 st, inc in next st, sc in next st, inc in next st [34]

Rnd 8: (*dark blue*) sc in next 17 st, (*off-white*) sc in next 17 st [34]

Rnd 9: (*dark blue*) inc in next st, sc in next st, inc in next st, sc in next 11 st, inc in next st, sc in next st, inc in next st, (*off-white*) inc in next st, sc in next st, inc in next st, sc in next 11 st, inc in next st, sc in next st, inc in next st [42] ②

Rnd 10: (*dark blue*) sc in next 21 st, (*off-white*) sc in next 21 st [42]

Insert the safety eyes between rounds 8 and 9, on the dark blue part of the head, with an interspace of approx. 14-16 stitches.

Rnd 11: (*dark blue*) inc in next st, sc in next st, inc in next st,

sc in next 15 st, inc in next st, sc in next st, inc in next st, *(off-white)* inc in next st, sc in next st, inc in next st, sc in next 15 st, inc in next st, sc in next st, inc in next st [50]

Rnd 12: *(dark blue)* sc in next 25 st, *(off-white)* sc in next 25 st [50]

Rnd 13: *(dark blue)* inc in next st, sc in next st, inc in next st, sc in next 19 st, inc in next st, sc in next st, inc in next st, *(off-white)* inc in next st, sc in next st, inc in next st, sc in next 19 st, inc in next st, sc in next st, inc in next st [58]

Rnd 14: *(dark blue)* sc in next 29 st, *(off-white)* sc in next 29 st [58]

Rnd 15: *(dark blue)* inc in next st, sc in next st, inc in next st, sc in next 23 st, inc in next st, sc in next st, inc in next st, *(off-white)* inc in next st, sc in next st, inc in next st, sc in

next 23 st, inc in next st, sc in next st, inc in next st [66]

Rnd 16 – 19: *(dark blue)* sc in next 33 st, *(off-white)* sc in next 33 st [66]

Rnd 20: *(dark blue)* inc in next st, sc in next st, inc in next st, sc in next 27 st, inc in next st, sc in next st, inc in next st, *(off-white)* inc in next st, sc in next st, inc in next st, sc in next 27 st, inc in next st, sc in next st, inc in next st [74]

Rnd 21 – 26: *(dark blue)* sc in next 37 st, *(off-white)* sc in next 37 st [74]

Rnd 27: *(dark blue)* dec, sc in next 33 st, dec, *(off-white)* dec, sc in next 33 st, dec [70]

Rnd 28 – 31: *(dark blue)* sc in next 35 st, *(off-white)* sc in next 35 st [70]

Rnd 32: *(dark blue)* sc in next st, dec, sc in next 29 st, dec,



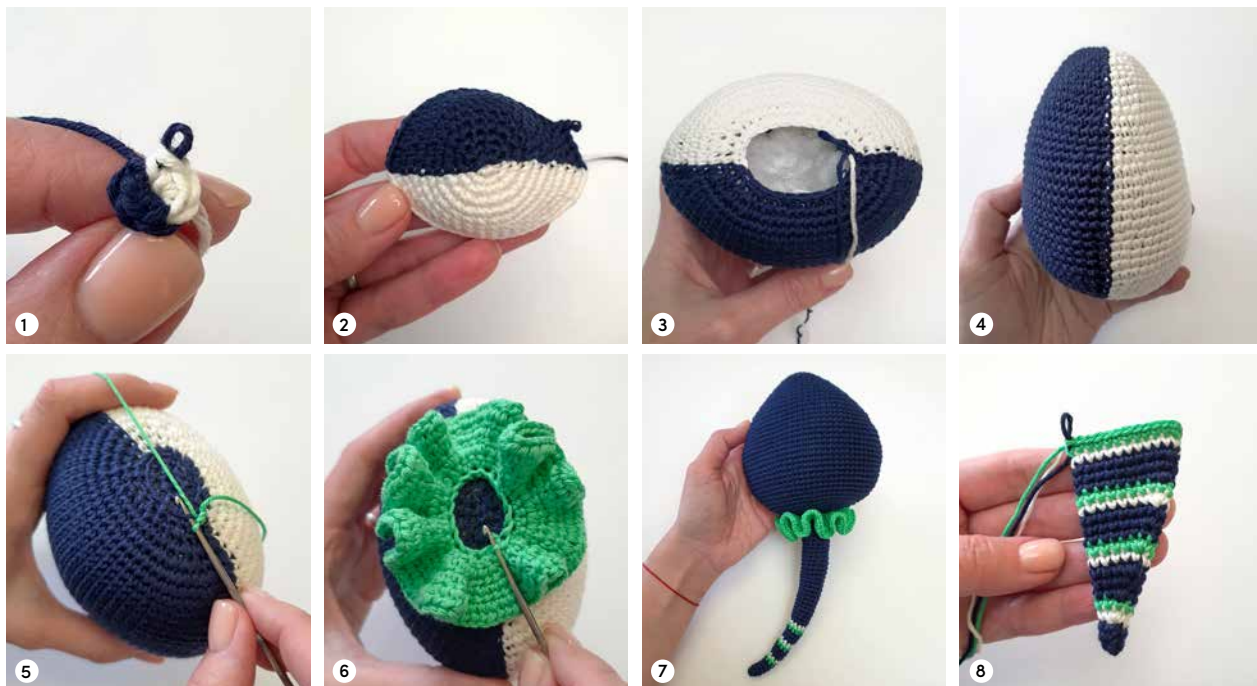

sc in next st, *(off-white)* sc in next st, dec, sc in next 29 st, dec, sc in next st [66]

Rnd 33 – 34: *(dark blue)* sc in next 33 st, *(off-white)* sc in next 33 st [66]

Rnd 35: *(dark blue)* dec, sc in next 27 st, dec 2 times, *(off-white)* dec, sc in next 27 st, dec 2 times [60]

Rnd 36 – 37: *(dark blue)* sc in next 30 st, *(off-white)* sc in next 30 st [60]

Rnd 38: *(dark blue)* (sc in next st, dec) repeat 3 times, sc in next 12 st, (dec, sc in next st) repeat 3 times, *(off-white)* (sc in next st, dec) repeat 3 times, sc in next 12 st, (dec, sc in next st) repeat 3 times [48]

Rnd 39: *(dark blue)* (sc in next st, dec) repeat 3 times, sc in next 6 st, (dec, sc in next st) repeat 3 times, *(off-white)* (sc in next st, dec) repeat 3 times, sc in next 6 st, (dec, sc in next st) repeat 3 times [36]

Stuff the head and body with fiberfill and continue stuffing as you go.

Rnd 40: *(dark blue)* (sc in next st, dec) repeat 6 times,

(off-white) (sc in next st, dec) repeat 6 times [24] ³

Change to dark blue yarn.

Rnd 41: sc in next st, dec, (sc in next 2 st, dec) repeat 5 times, sc in next st [18]

Rnd 42: BLO (sc in next st, dec) repeat 6 times [12]

Rnd 43: dec 6 times [6]

Fasten off, leaving a yarn tail. Using a yarn needle, weave the yarn tail through the front loop of each remaining stitch and pull it tight to close. Weave in the yarn end ⁴.

FRILL (in spring green yarn)

Go back to round 41 of the body. Pull up a loop of spring green yarn in the first leftover front loop and start crocheting the frill ⁵.

Rnd 1: FLO sc in all 18 st [18]

Rnd 2: FLO inc in all 18 st [36]

Rnd 3: 2 hdc in all 36 st [72]

Rnd 4: (sc in next st, 2 hdc in next st) repeat 36 times [108]

Rnd 5: (sc in next st, 2 hdc in next st) repeat 54 times [162]

Sc in next st, slst in next st. Fasten off and weave in the yarn end.

TAIL (start in dark blue yarn)

Note: You can insert a piece of wire or pipe cleaner into the tail before stuffing it, to make it bendable.

Go back to round 1 of the frill. Pull up a loop of dark blue yarn in the first leftover back loop **6** and start crocheting the tail.

Rnd 1: BL0 sc in all 18 st [18]

Rnd 2 – 7: sc in all 18 st [18]

Rnd 8: (sc in next 7 st, dec) repeat 2 times [16]

Rnd 9 – 14: sc in all 16 st [16]

Stuff the tail with fiberfill and continue stuffing as you go.

Rnd 15: (sc in next 6 st, dec) repeat 2 times [14]

Rnd 16 – 22: sc in all 14 st [14]

Rnd 23: (sc in next 5 st, dec) repeat 2 times [12]

Rnd 24 – 26: sc in all 12 st [12]

Change to off-white yarn and crochet the tail in a stripe pattern, alternating 1 round in off-white yarn, 1 round in spring green yarn and 3 rounds in dark blue yarn. The color change is indicated in italics.

Rnd 27: *(off-white)* sc in all 12 st [12]

Rnd 28: *(spring green)* sc in all 12 st [12]

Rnd 29: *(dark blue)* sc in all 12 st [12]

Rnd 30: *(dark blue)* (sc in next 4 st, dec) repeat 2 times [10]

Rnd 31: *(dark blue)* sc in all 10 st [10]

Rnd 32: *(off-white)* sc in all 10 st [10]

Rnd 33: *(spring green)* sc in all 10 st [10]

Rnd 34 – 36: *(dark blue)* sc in all 10 st [10]

Rnd 37: *(off-white)* (sc in next 3 st, dec) repeat 2 times [8]

Rnd 38: *(spring green)* sc in all 8 st [8]

Change to dark blue yarn.

Rnd 39 – 43: sc in all 8 st [8]

Rnd 44: (sc in next 2 st, dec) repeat 2 times [6]

Fasten off, leaving a yarn tail. Using a yarn needle, weave the yarn tail through the front loop of each remaining stitch and pull it tight to close. Weave in the yarn end **7**.





BIG LATERAL FIN (make 2, start in dark blue yarn)

Crochet the fin in a stripe pattern, alternating 3 rounds in dark blue yarn, 1 round in off-white yarn and 1 round in spring green yarn. The color change is indicated in italics.

Rnd 1: *(dark blue)* start 5 sc in a magic ring [5]

Rnd 2: *(dark blue)* sc in next 2 st, 3 sc in next st, sc in next 2 st [7]

Rnd 3: *(dark blue)* sc in all 7 st [7]

Rnd 4: *(off-white)* sc in next 3 st, 3 sc in next st, sc in next 3 st [9]

Rnd 5: *(spring green)* sc in all 9 st [9]

Rnd 6: *(dark blue)* sc in next 4 st, 3 sc in next st, sc in next 4 st [11]

Rnd 7: *(dark blue)* sc in all 11 st [11]

Rnd 8: *(dark blue)* sc in next 5 st, 3 sc in next st, sc in next 5 st [13]

Rnd 9: *(off-white)* sc in all 13 st [13]

Rnd 10: *(spring green)* sc in next 6 st, 3 sc in next st, sc in next 6 st [15]

Rnd 11: *(dark blue)* sc in all 15 st [15]

Rnd 12: *(dark blue)* sc in next 7 st, 3 sc in next st, sc in next 7 st [17]

Rnd 13: *(dark blue)* sc in all 17 st [17]

Rnd 14: *(off-white)* sc in next 8 st, 3 sc in next st, sc in next 8 st [19]

Rnd 15: *(spring green)* sc in all 19 st [19]

Rnd 16: *(dark blue)* sc in next 9 st, 3 sc in next st, sc in next 9 st [21]

Rnd 17: *(dark blue)* sc in all 21 st [21]

Rnd 18: *(dark blue)* sc in next 10 st, 3 sc in next st, sc in next 10 st [23]

Rnd 19: *(off-white)* sc in all 23 st [23]

Rnd 20: *(spring green)* sc in next 11 st, 3 sc in next st, sc in next 11 st [25] **8**

Rnd 21 – 23: *(dark blue)* sc in next 5 st, hdc in next 5 st, dc in next 5 st, hdc in next 5 st, sc in next 5 st [25] **9**

Rnd 24: *(off-white)* sc in next 11 st, sc3tog, sc in next 11 st [23]

Rnd 25: *(spring green)* sc in all 23 st [23]

Rnd 26: *(dark blue)* sc in next 10 st, sc3tog, sc in next 10 st [21]

Rnd 27: *(dark blue)* sc in all 21 st [21]

Rnd 28: *(dark blue)* sc in next 9 st, sc3tog, sc in next 9 st [19]

Rnd 29: *(off-white)* sc in all 19 st [19]

Rnd 30: *(spring green)* sc in next 8 st, sc3tog, sc in next 8 st [17]

Rnd 31: *(dark blue)* sc in all 17 st [17]

Rnd 32: *(dark blue)* sc in next 7 st, sc3tog, sc in next 7 st [15]

Rnd 33: *(dark blue)* sc in all 15 st [15]

Rnd 34: *(off-white)* sc in next 6 st, sc3tog, sc in next 6 st [13]

Rnd 35: *(spring green)* sc in all 13 st [13]

Rnd 36: *(dark blue)* sc in next 5 st, sc3tog, sc in next 5 st [11]

Rnd 37: *(dark blue)* sc in all 11 st [11]

Rnd 38: *(dark blue)* sc in next 4 st, sc3tog, sc in next 4 st [9]

Rnd 39: *(off-white)* sc in all 9 st [9]

Rnd 40: *(spring green)* sc in next 3 st, sc3tog, sc in next 3 st [7]

Rnd 41: *(dark blue)* sc in all 7 st [7]

Rnd 42: *(dark blue)* sc in next 2 st, sc3tog, sc in next 2 st [5]

The fin doesn't need to be stuffed. Fasten off, leaving a yarn tail. Using a yarn needle, weave the yarn tail through the front



loop of each remaining stitch and pull it tight to close. Weave in the yarn end ¹⁰.

Pin the fins symmetrically to the sides of the head and body, between rounds 5 and 41, and sew them on using dark blue yarn ¹¹ ¹².

SMALL LATERAL FIN (make 2, in off-white yarn)

Rnd 1: start 6 sc in a magic ring [6]

Rnd 2: inc in all 6 st [12]

Rnd 3: {sc in next st, inc in next st} repeat 6 times [18]

Rnd 4: sc in next st, inc in next st, {sc in next 2 st, inc in next st} repeat 5 times, sc in next st [24]

Rnd 5 – 6: sc in all 24 st [24]

Rnd 7: sc in next st, dec, {sc in next 2 st, dec} repeat 5 times, sc in next st [18]

Rnd 8 – 9: sc in all 18 st [18]

Rnd 10: {sc in next st, dec} repeat 6 times [12]

Rnd 11 – 12: sc in all 12 st [12]

Rnd 13: dec 6 times [6]

Rnd 14: sc in all 6 st [6]

Slst in next st. Fasten off, leaving a long tail for sewing.

The fin doesn't need to be stuffed. Pin and sew the fins symmetrically to the sides of the tail, underneath the frill ¹³.

LARGE SPOT (make 3, in spring green yarn)

Rnd 1: start 6 sc in a magic ring [6]

Rnd 2: inc in all 6 st [12]

Slst in next st. Fasten off and weave in the yarn end.

SMALL SPOT (make 5, in spring green yarn)

Rnd 1: start 6 sc in a magic ring [6]

Slst in next st. Fasten off and weave in the yarn end.

Pin and sew all spots to the back of the body. As these parts are very small, I highly recommend using a thread or a single strand of spring green yarn for sewing ¹⁴.

MOUTH (in off-white yarn)

Ch 25 and join with a slst to make a circle. Make sure the chain isn't twisted.

Rnd 1: slst in all 25 ch [25]

Fasten off and weave in the yarn end ¹⁵. As this part is very small, I highly recommend using a thread or a single strand of off-white yarn for sewing. Sew the mouth to the front of the body, between rounds 18 and 23 ¹⁶.

FINISHING TOUCHES

- Use scraps of pink, spring green and dark blue yarn to embroider straight stitches on the front of the head and body and the small lateral fins.
- Use scraps of off-white yarn to embroider French knots on the back of the head and body.

