



Abbreviations

X: single crochet, **V:** increase, **A:** decrease, **CH:** chain, **SS:** slip stitch, **T:** half double crochet, **TV:** half double crochet increase (make 2T in one stitch), **TA:** half double crochet decrease (make a T from 2 sts), **F:** double crochet, **W:** 3 single crochet in 1 sts, **BLO:** back loop only, **FLO:** front loop only, **STS:** stitches.

1. Rabbit (White)

Head (white)

R1: Magic Ring 6X

R2: 6V

R3: (X, V) * 6

R4: (X, V, X) * 6

R5: (3X, V) * 6

R6: (2X, V, 2X) * 6

R7: (5X, V) * 6

R8: (3X, V, 3X) * 6

R9-16: 48X

R17: (3X, A, 3X) * 6

R18: (5X, A) * 6

R19: (2X, A, 2X) * 6

R20: (3X, A) * 6

R21: (X, A, X) * 6

Slst and fasten off. Leave long tail for sewing to body.

Just follow the pattern and finish the head. ***You may refer photo 1.***

Legs (white) * 2

R1-3: Magic Ring 9X

R4: Join both two legs: 18X

You may refer photo 2: How to join legs + body.



Body (white)

R5-9: Magic Ring 18X

Slst and fasten off.

Hand (white) * 2

R1: Magic Ring 6X

R2-3: 6X

Slst and fasten off.

You may refer photo 3: For tips on hands.

Ears (white) * 2

R1: Magic Ring 6X

R2: 6V

R3-7: 12X

Sew the ears between R3-5 on the head.

Place safety eyes between R12 and R13. The distance between both safety eyes is 6 stitches.



Dress (pink)

R1: 22CH, slip stitch heads with tail into a circle. Do 22F in circle.

R2: 4X, 5CH, skip 3 stitches, 8X, 5CH, skip 3 stitches,

4X5CH to make 2 shoulder straps.

You may refer Photo 4: The dress and Photo: 5 How to dress straps.

2. Rabbit (grey)

Head (grey)

R1: Magic Ring 6X

R2: 6V

R3: (X, V) * 6

R4: (X, V, X) * 6

R5: (3X, V) * 6

R6: (2X, V, 2X) * 6

R7: (5X, V) * 6

R8: (3X, V, 3X) * 6

R9-16: 48X

R17: (3X, A, 3X) * 6

R18: (5X, A) * 6

R19: (2X, A, 2X) * 6

R20: (3X, A) * 6

R21: (X, A, X) * 6

Slst and fasten off. Leave long tail for sewing to body.

Just follow the pattern and finish the head. ***You may refer photo 1.***

Legs (grey) * 2

R1-3: Magic Ring 9X

R4: Join both two legs: 18X

You may refer photo 2: How to join legs + body.



Body (grey)

R5-9: Magic Ring 18X

Slst and fasten off.

Hand (grey) * 2

R1: Magic Ring 6X

R2-3: 6X

Slst and fasten off.

You may refer photo 3: For tips on hands.

Ears * 2

R1: 16CH, 6X, 8T, Into 1 stitch: 5T, 8T, 6X, 1CH, Turn over

R2: 6X, 8T, 5TV, 8T, 6X

Sew the ears on R8.

Sew the eyebrow above the eyes.

Place safety eyes between R12 and R13. The space between two holes that you put safety eyes is 7 stitches.

Leaf (green)

R1: 10CH, reverse 1 stitch: 2T, X, SL, X, 2T, W, 2T, X, SL, X, 2T, V

Dress 2 (pink)

R1: 22CH, 22F in circle

R2: 4X, 5CH, skip 3 stitches, 8X, 5CH, skip 3 stitches,

4X5CH to make 2 shoulder straps.

You may refer Photo 4: The dress and Photo: 5 How to dress straps.

3. Elephant (blue)

Head (blue)

R1: Magic Ring 6X

R2: 6V

R3: (X, V) * 6

R4: (X, V, X) * 6

R5: (3X, V) * 6

R6: (2X, V, 2X) * 6

R7: (5X, V) * 6

R8: (3X, V, 3X) * 6

R9-16: 48X

R17: (3X, A, 3X) * 6

R18: (5X, A) * 6

R19: (2X, A, 2X) * 6

R20: (3X, A) * 6

R21: (X, A, X) * 6

Slst and fasten off. Leave long tail for sewing to body.

Just follow the pattern and finish the head. ***You may refer photo 1.***

Legs (blue) * 2

R1-3: Magic Ring 9X

R4: Join both two legs: 18X

You may refer photo 2: How to join legs + body.



Body (blue)

R5-9: Magic Ring 18X

Slst and fasten off.

Hand (blue) * 2

R1: Magic Ring 6X

R2-3: 6X

Slst and fasten off.

You may refer photo 3: For tips on hands.

Ears * 2

Note: You have to Chain3, turn over every end of the working piece.
(Chain 3= also count as 1 Double Crochet in next R)

R1: Magic Ring 8F

R2: 2F, 4FV, 2F

R3: 4F, 4FV, 4F

Sew the ears on R6-18.

Place safety eyes between R12 and R13. The space between two holes that you put safety eyes is 6 stitches.

Nose

R1: Magic Ring 8X

R2-5: 8X

Sew it on R13-14.

Pants (dark blue)

R1: 11CH, 11X in circle

R2: 11X

R1 & R2 make 2, then join both pieces into 1: 22X

R4: 22X

R5: 4X, 5CH, skip 3 stitches, 8X, 5CH, skip 3 stitches,
4X5CH to make 2 shoulder straps.

You may refer photo 6: The pants and Photo 7: How to strap the pants.

4. Bear (brown)

Head (blue)

R1: Magic Ring 6X

R2: 6V

R3: (X, V) * 6

R4: (X, V, X) * 6

R5: (3X, V) * 6

R6: (2X, V, 2X) * 6

R7: (5X, V) * 6

R8: (3X, V, 3X) * 6

R9-16: 48X

R17: (3X, A, 3X) * 6



R18: (5X, A) * 6

R19: (2X, A, 2X) * 6

R20: (3X, A) * 6

R21: (X, A, X) * 6

Slst and fasten off. Leave long tail for sewing to body.

Just follow the pattern and finish the head. ***You may refer photo 1.***

Legs (brown) * 2

R1-3: Magic Ring 9X

R4: Join both two legs: 18X

You may refer photo 2: How to join legs + body.

Body (brown)

R5-9: Magic Ring 18X

Slst and fasten off.

Hand (brown) * 2

R1: Magic Ring 6X

R2-3: 6X

Slst and fasten off.

You may refer photo 3: For tips on hands.

Ears (brown) * 2

R1: Magic Ring 6X

R2: 6V

Sew the ears on R4-7.

Place safety eyes between R12 and R13. The space between two holes that you put safety eyes is 6 stitches

Mouth (white)

R1: Magic Ring 8X

R2: 8V

Leave long yarn sew to head. Use black yarn sew out the nose.

Pants (dark blue)

R1: 11CH, 11X in circle

R2: 11X

R1 & R2 make 2, then join both pieces into 1: 22X

R4: 22X

**R5: 4X, 5CH, skip 3 stitches, 8X, 5CH, skip 3 stitches,
4X5CH to make 2 shoulder straps.**

You may refer photo 6: The pants and Photo 7: How to strap the pants.

5. Giraffe (light brown)

Head (light brown)

R1: Magic Ring 6X

R2: 6V

R3: (X, V) * 6

R4: (X, V, X) * 6

R5: (3X, V) * 6

R6: (2X, V, 2X) * 6

R7: (5X, V) * 6

R8: (3X, V, 3X) * 6

R9-16: 48X

R17: (3X, A, 3X) * 6

R18: (5X, A) * 6

R19: (2X, A, 2X) * 6

R20: (3X, A) * 6

R21: (X, A, X) * 6

Slst and fasten off. Leave long tail for sewing to body.

Just follow the pattern and finish the head. ***You may refer photo 1.***



Legs (light brown) * 2

R1-3: Magic Ring 9X

R4: Join both two legs: 18X

You may refer photo 2: How to join legs + body.

Body (light brown)

R5-9: Magic Ring 18X

Slst and fasten off.

Hand (light brown) * 2

R1: Magic Ring 6X

R2-3: 6X

Slst and fasten off.

You may refer photo 3: For tips on hands.

Ears (light brown) * 2

R1: 6X

R2: 6V

R3: (X, V) * 6

R4-7: 18X

Sew the ears on R6-8.

Place safety eyes between R10 and R11. The space between two holes that you put safety eyes is 6 stitches.

Horn * 2

Begin with dark brown.

R1-3: Magic Ring 8X

R4-7: Change to yellow, 8X

Sew the horns on R3-5

Mouth (white)

R1: 4CH, working on 2nd stitch: 2X, W, X, V (Slip stitch, Chain 1)

R2: V, X, 3V, X, 2V

Sew it on R12-16 to head.

Pants (dark blue) * 2

R1: 11CH, 11X in circle

R2: 11X

R1 & R2 make 2, then join both pieces into 1: 22X

R4: 22X

R5: 4X, 5CH, skip 3 stitches, 8X, 5CH, skip 3

stitches,

4X5CH to make 2 shoulder straps.

You may refer photo 6: The pants and Photo 7: How to strap the pants.

6. Dog (light grey)

Head (light grey)

R1: **Magic Ring** 6X

R2: 6V

R3: (X, V) * 6

R4: (2X, V) * 6

R5: (3X, V) * 6

R6: (4X, V) * 6

R7: (5X, V) * 6

R8: (6X, V) * 6



R9: 16X, 6X (white), 3X, 6X (white), 17X
R10: 15X, 7X (white), 3X, 7X (white), 16X
R11: 14X, 8X (white), 3X, 8X (white), 15X
R12: 13X, 21X (white), 14X
R13-16: 12X, 23X (white), 13X
R17: 3X, A, 6X, [white: A, 6X, A, 6X, A, 5X], X, A, 6X, A, 3X
R18: 5X, A, 4X, [white: X, A, 5X, A, 5X, A, X], 4X, A, 5X, A
R19: 2X, A, 4X, A, [white: 4X, A, 4X, A, 2X], 2X, A, 4X, A, 2X
R20: 3X, A, 3X, A, [white: 3X, A, 3X, A], 3X, A, 3X, A
R21: X, A, 2X, A, 2X, [white: A, 2X, A], 2X, A, 2X, A, X
Slst and fasten off. Leave long tail for sewing to body.
Just follow the pattern and finish the head.

Body & Legs (light grey) * 2

R1: Magic Ring 9X

R2-3: 9X

R1-R3 Make 2, fasten off 1 leg.

R4-8: Join both legs into 1: 18X

You may refer photo 2: How to join legs + body.

Hand (light grey) * 2

R1: Magic Ring 6X

R2-3: 6X

Slst and fasten off.

You may refer photo 3: For tips on hands.

Ears * 2

R1: 5X in circle

R2: 2V, white: V, 2X

R3: 4X, white: 2V, 4X

R4: 3X, V, [white: 4X], V, 3X

R5: X, V, X, V, X, [white: V, 2X, V], X, V, X, V, X

R6: 7X, white: 6X, 7X

Place safety eyes between R12 and R13. The space between two holes that you put safety eyes is 8 stitches.

Mouth (white)

R1: 6CH, reverse 4 stitches: W, 3X, V

R2: V, 3X, W, 3X, 2V

R3: 18X

Pants (light blue)

R1: 11CH, 11X in circle

R2: 11X

R1 & R2 make 2, then join both pieces into 1: 22X

R4: 22X

R5: 4X, 5CH, skip 3 stitches, 8X, 5CH, skip 3 stitches,
4X5CH to make 2 shoulder straps.

You may refer photo 6: The pants and Photo 7: How to strap the pants.

7. Dog (light brown)

Head (light brown)

NOTE: R1-11: light brown, R12-21: white. R1: Magic Ring 6X

R2: 6V

R3: (X, V) * 6

R4: (X, V, X) * 6

R5: (3X, V) * 6

R6: (2X, V, 2X) * 6

R7: (5X, V) * 6

R8: (3X, V, 3X) * 6

R9-16: 48X

R17: (3X, A, 3X) * 6

R18: (5X, A) * 6

R19: (2X, A, 2X) * 6

R20: (3X, A) * 6

R21: (X, A, X) * 6

Slst and fasten off. Hide the yarn.



Legs (light brown) * 2

R1-3: Magic Ring 9X

R4: Join both two legs: 18X

You may refer photo 2: How to join legs + body.

Body (light brown)

R5-9: Magic Ring 18X

Slst and fasten off.

Hand (light brown) * 2

R1: 6X in Magic circle

R2-3: 6X

Slst and fasten off.

You may refer photo 3: For tips on hands.

Ears * 2

R1: 6X

R2: (X, V) * 3

R3: 9X

R4: (X, V, X) * 3

R5: (3X, V) * 3

Inner (yellow)

R1: 4CH, reverse 1 stitch, T, F

Place safety eyes between R12 and R13. The space between two holes that you put safety eyes is 8 stitches.

Mouth (white)

R1: 6X

R2: 6V

R3: 12X

Dress 2 (pink)

R1: 22CH, 22X in circle

R2: 3X, 4V, 7X, 4V, 4X

5CH to make 2 shoulder straps.

You may refer Photo 8 : Dress 2 and Photo 9: how to Dress 2 straps.

8. Panda (white)

Head (white)

R1: Magic Ring 6X

R2: 6V

R3: (X, V) * 6

R4: (X, V, X) * 6

R5: (3X, V) * 6

R6: (2X, V, 2X) * 6

R7: (5X, V) * 6



R8: (3X, V, 3X) * 6

R9-16: 48X

R17: (3X, A, 3X) * 6

R18: (5X, A) * 6

R19: (2X, A, 2X) * 6

R20: (3X, A) * 6

R21: (X, A, X) * 6

Slst and fasten off. Leave long tail for sewing to body.

Just follow the pattern and finish the head. ***You may refer photo 1.***

Legs (white) * 2

R1-3: Magic Ring 9X

R4: Join both two legs: 18X

You may refer photo 2: How to join legs + body.

Body (white)

R5-9: Magic Ring 18X

Slst and fasten off.

Hand (white) * 2

R1: Magic Ring 6X

R2-3: 6X

Slst and fasten off.

You may refer photo 3: For tips on hands.

Ears * 2

R1: Magic Ring 6X

R2: 6V

R3: (X, V) * 6

R4-6: 18X

R7: (X, V) * 6

Sew the ears on R4-9. Sew the nose on R12-13.

Place safety eyes between R10 and R12. The space between two holes that you put safety eyes is 7 stitches.

Bow (red)

R1: (2CH, 2F, 2CH, SL) * 2

Dress (red)

R1: 22CH, 22X in circle

R2: 3X, 4V, 7X, 4V, 4X

5CH to make 2 shoulder straps.

You may refer Photo 8 : Dress 2 and Photo 9: how to Dress 2 straps.

9. Lion (yellow)

Head (yellow)

R1: Magic Ring 6X

R2: 6V

R3: (X, V) * 6

R4: (X, V, X) * 6

R5: (3X, V) * 6

R6: (2X, V, 2X) * 6

R7: (5X, V) * 6

R8: (3X, V, 3X) * 6

R9-16: 48X

R17: (3X, A, 3X) * 6

R18: (5X, A) * 6

R19: (2X, A, 2X) * 6

R20: (3X, A) * 6

R21: (X, A, X) * 6



Slst and fasten off. Leave long tail for sewing to body.

Just follow the pattern and finish the head. ***You may refer photo 1.***

Legs (yellow) * 2

R1-3: Magic Ring 9X

R4: Join both two legs: 18X

You may refer photo 2: How to join legs + body.

Body (yellow)

R5-9: Magic Ring 18X

Slst and fasten off.

Hand (yellow) * 2

R1: Magic Ring 6X

R2-3: 6X

Slst and fasten off.

You may refer photo 3: For tips on hands.

Ears * 2

R1: Magic Ring 6X

R2: 6V

Place safety eyes between R12 and R13. The space between two holes that you put safety eyes is 5 stitches.

Mane (dark brown)

R1: 48CH in circle, reverse: [2SL, 2FV] * 12

Sew to R7-8.

Mouth (white)

R1: Magic Ring 6X

R2: 6V

Dress (light blue)

R1: 22CH, 22X in circle

R2: 3X, 4V, 7X, 4V, 4X

5CH to make 2 shoulder straps.

You may refer Photo 8 : Dress 2 and Photo 9: how to Dress 2 straps.

10. Totoro (grey)

Head (grey)

R1: Magic Ring 6X

R2: 6V

R3: (X, V) * 6

R4: (X, V, X) * 6

R5: (3X, V) * 6

R6: (2X, V, 2X) * 6

R7: (5X, V) * 6

R8: (3X, V, 3X) * 6

R9-16: 48X

R17: (3X, A, 3X) * 6

R18: (5X, A) * 6

R19: (2X, A, 2X) * 6

R20: (3X, A) * 6

R21: (X, A, X) * 6

Slst and fasten off. Leave long tail for sewing to body.

Just follow the pattern and finish the head. ***You may refer photo 1.***

Legs (grey) * 2

R1-3: Magic Ring 9X



R4: Join both two legs: 18X

You may refer photo 2: How to join legs + body.

Body (grey)

R5-9: Magic Ring 18X

Slst and fasten off.

Hand (grey) * 2

R1: Magic Ring 6X

R2-3: 6X

Slst and fasten off.

You may refer photo 3: For tips on hands.

Ears * 2

R1: Magic Ring 6X

R2: 6X

R3: 6V

R4-6: 12X

R7: 6V

Sew the ears on R4-5.

Place safety eyes between R11 and R12.

Leaf (green)

R1: 7CH, reverse 1 stitch: T, 2F, T, W, T, 2F, T, V

Pants (dark blue)

R1: 11CH, 11X in circle

R2: 11X

R1 & R2 make 2, then join both pieces into 1: 22X

R4: 22X

R5: 4X, 5CH, skip 3 stitches, 8X, 5CH, skip 3 stitches,
4X5CH to make 2 shoulder straps.

You may refer photo 6: The pants and Photo 7: How to strap the pants.

11. Pig (skin color)

Head (skin color)

R1: Magic Ring 6X

R2: 6V

R3: (X, V) * 6

R4: (X, V, X) * 6

R5: (3X, V) * 6

R6: (2X, V, 2X) * 6

R7: (5X, V) * 6

R8: (3X, V, 3X) * 6

R9-16: 48X

R17: (3X, A, 3X) * 6

R18: (5X, A) * 6

R19: (2X, A, 2X) * 6

R20: (3X, A) * 6



R21: (X, A, X) * 6

Slst and fasten off. Leave long tail for sewing to body.

Just follow the pattern and finish the head. ***You may refer photo 1.***

Legs (skin colour) * 2

R1-3: Magic Ring 9X

R4: Join both two legs: 18X

You may refer photo 2: How to join legs + body.

Body (skin colour)

R5-9: Magic Ring 18X

Slst and fasten off.

Hand (skin colour) * 2

R1: 6X in Magic circle

R2-3: 6X

Slst and fasten off.

You may refer photo 3: For tips on hands.

Ears * 2

R1: Magic Ring 7X, Chain1, turn over

R2: 3X, W, 3X

Sew the ears on R4-6.

Place safety eyes between R12 and R13. The space between two holes that you put safety eyes is 7 stitches.

Nose (light pink)

R1: 4CH, working on 2nd stitch: 2X, W, X, V (Slip stitch, Chain 1)

R2: V, X, 3V, X, 2V

With white colour yarn sew the nose, then sew it on R12-16 to head.

Dress 2 (dark pink)

R1: 22CH, 22X in circle

R2: 3X, 4V, 7X, 4V, 4X

5CH to make 2 shoulder straps.

You may refer Photo 8 : Dress 2 and Photo 9: how to Dress 2 straps.

PHOTOS

Photo 1: How to crochet head.

The head pattern for all dolls are the same. Except for dog (light grey) which got colour changes in it.



Photo 2 : How to join legs + body.

The ways to join legs and body pattern for all 11 dolls are the same.



Fasten Off only left leg. Once u done right leg insert hook into left leg and do single crochet, X to join both legs together. Then continue to body.

Photo 3: Tips on hands.



Once I done, I use the tweezer and insert some of the yarn into the hand. Excess yarn is cut off.

Photo 4: The dress.

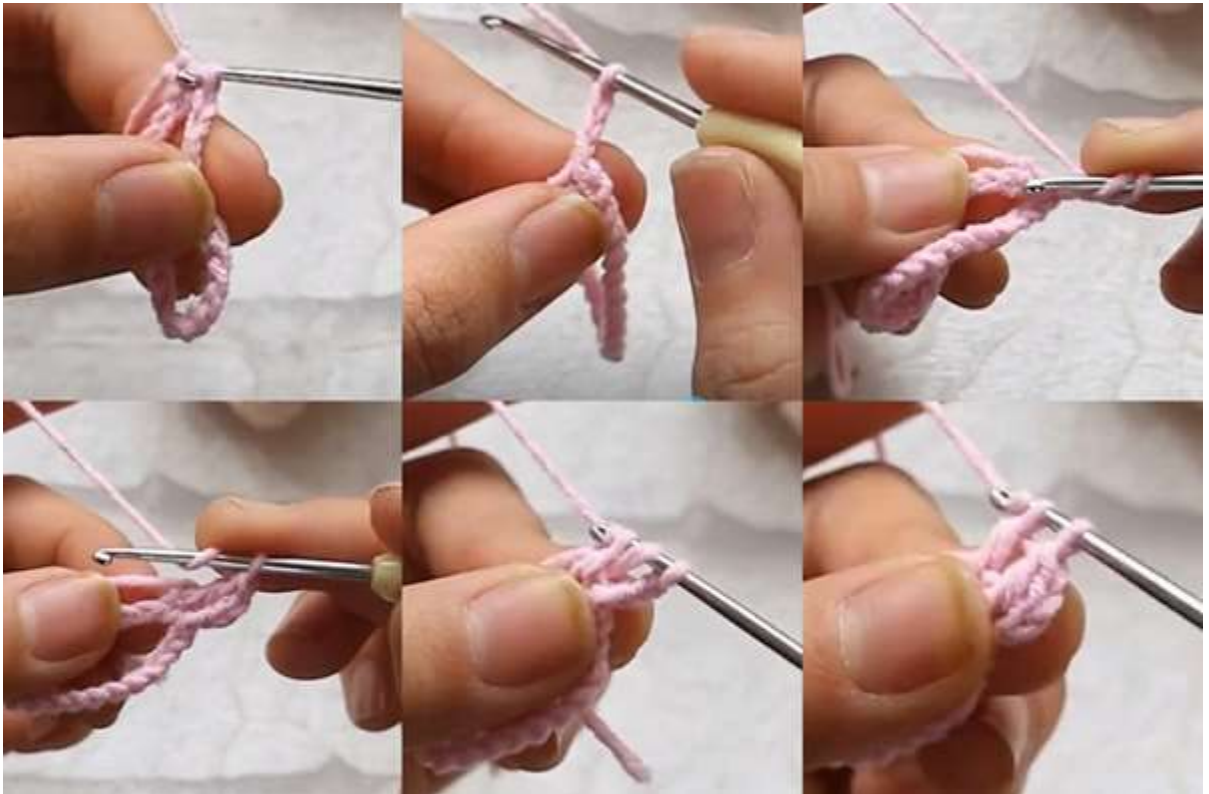



Photo 5: How to dress straps.



Photo 6: The pants.

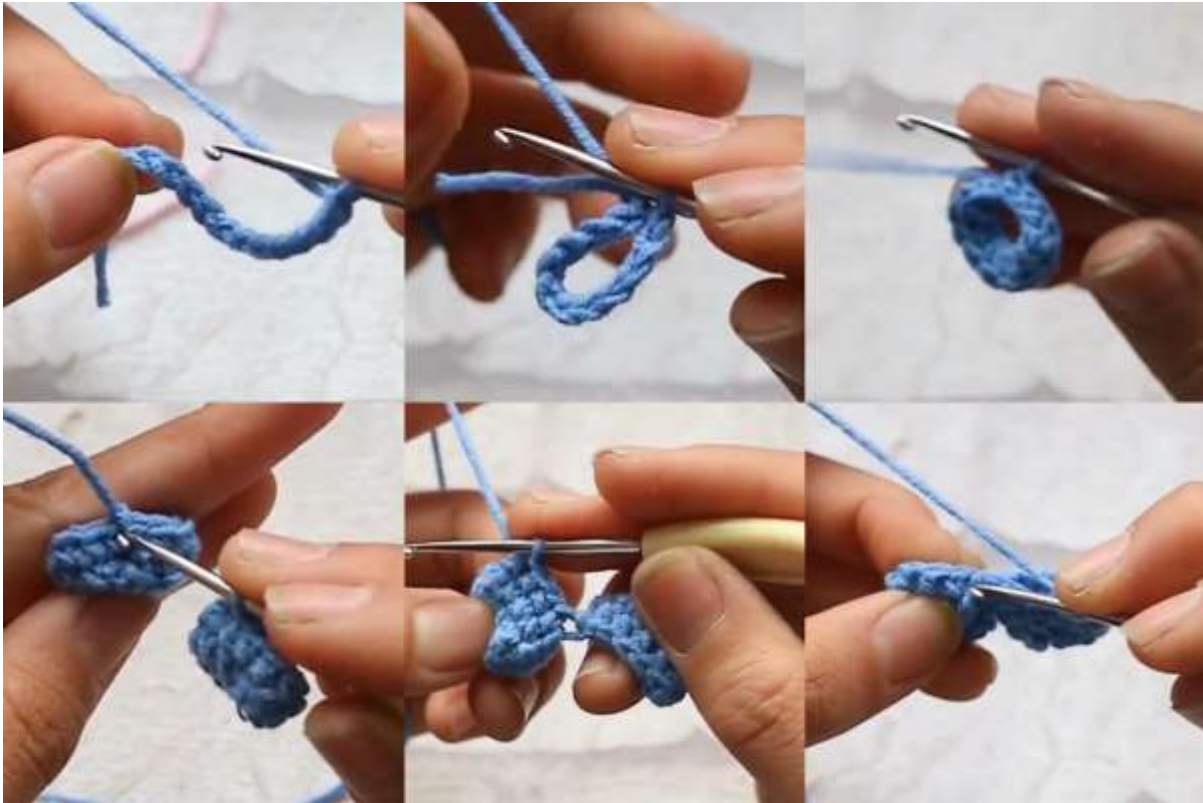

Photo 7: How to strap the pants.

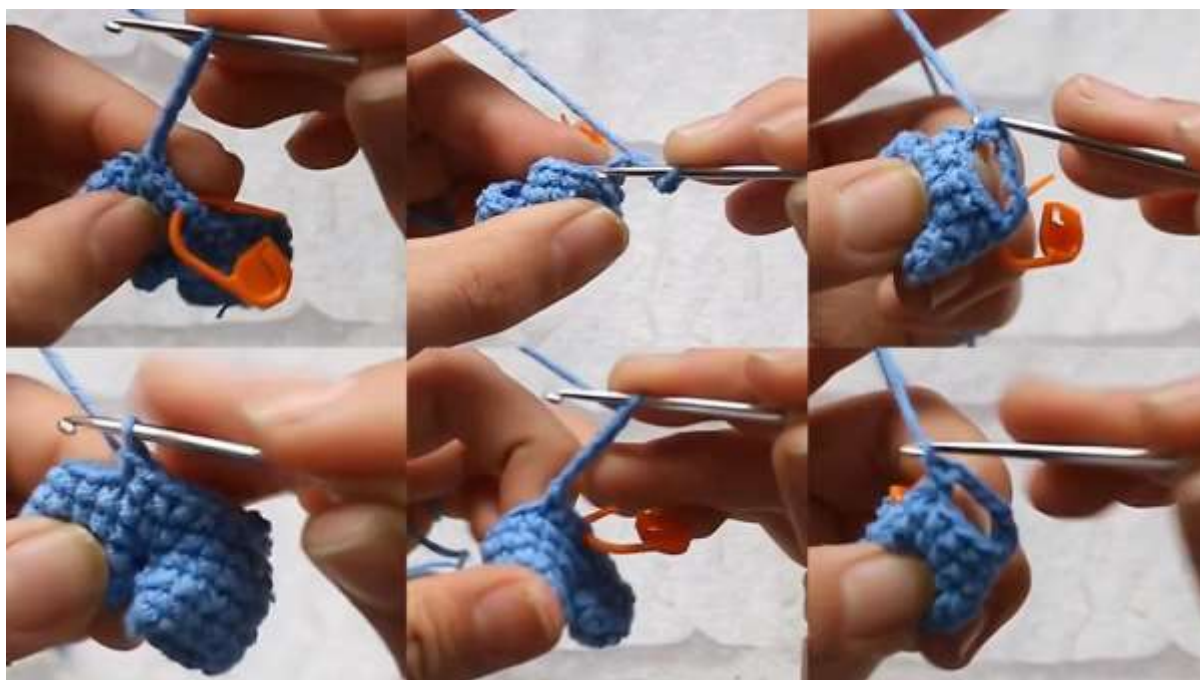
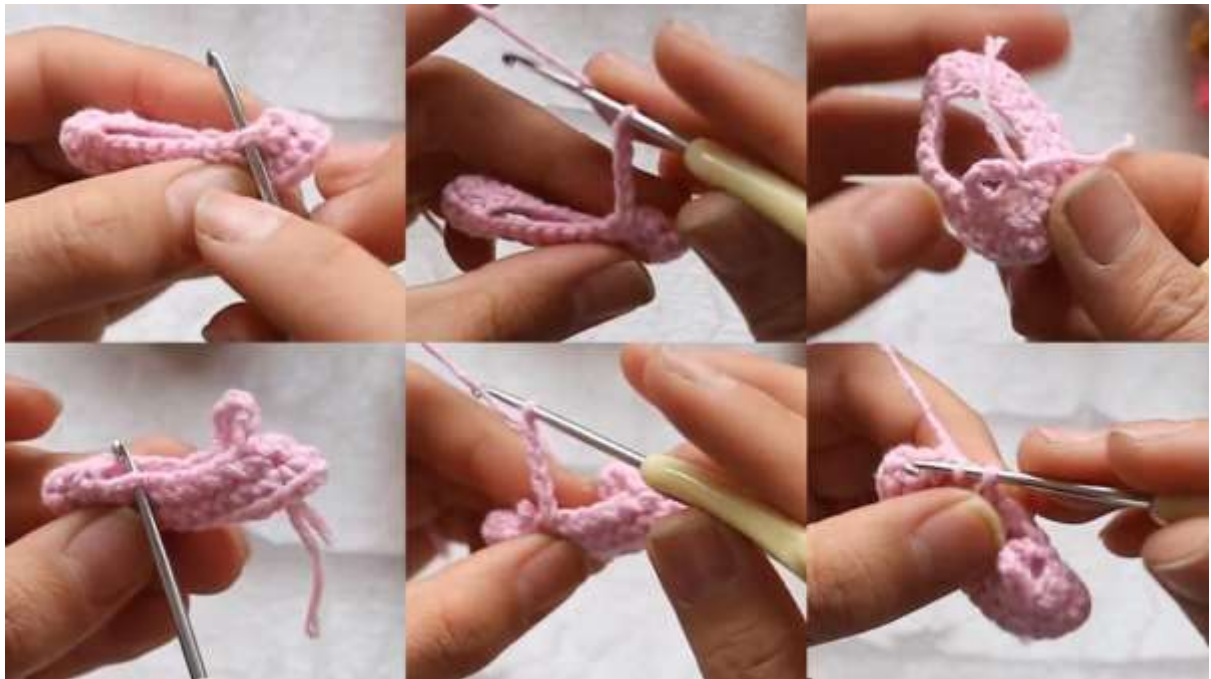

Photo 8: Dress 2



Photo 9: How to dress 2 straps.



ASSEMBLE

There are 2 ways to join the hands to the body. You can use any of the methods to join the hands to body.

First method, you may use some yarn sew the hands to the body.



Second method, you can use hot glue to glue the hands to the body.



Use the excess yarn from the head, sew the head with the body. You can use any method you prefer to sew them together.

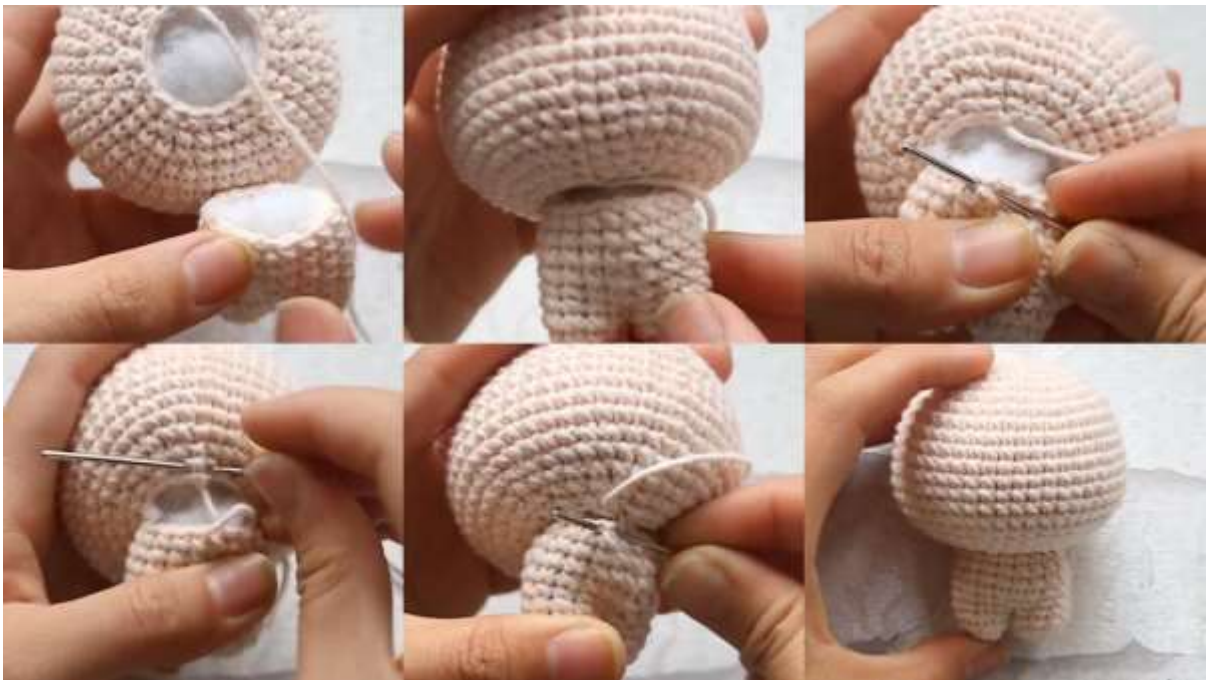

Note

Crochet the doll with tight stitches.

You can join rounds with slip stitch or turn.

A stitch marker or a piece of yarn to mark the ending of the round. It's highly recommended that you read through the pattern completely before beginning to crochet.

Materials & Tools

There is no special yarn requirement for the pattern. You may work with the yarn you prefer.

You can use the same pattern to make smaller or larger toy by using finer or bulkier yarn.

Crochet hook suitable with your yarns.

Pink blush makeup powder or pink acrylic paint.